

YELLOWSTONE COUNTY, MONTANA
Invitation For Bid
Metra Skybox Renovation

1. Introduction

Notice is hereby given that Yellowstone County is seeking bids from qualified vendors for light renovations of the Skybox Suites in the First Interstate Arena, located on the MetraPark campus at 308 6th Avenue North, Billings, MT 59101. Bids should include the cost of all materials, permits, labor and equipment necessary to complete the project. For complete scope of work, please see attached Exhibit A – Construction Documents. The awarded contractor will be expected to coordinate with Metrapark staff to schedule work during times that will not interfere with events scheduled in the First Interstate Arena.

2. Bid Submission Requirements

In order to provide a complete understanding of the project, a mandatory, in-person Pre-Bid Meeting will be held on Wednesday, November 12th, 2025, at 2:00PM. Participants should meet in the lobby of the First Interstate Arena at MetraPark, located at 308 6th Ave North, Billings, MT 59101. Attendance will be taken. Bids submitted without a representative attending the pre-bid meeting will not be considered.

Offerors shall submit five (5) hard copies of the bid in a sealed envelope. All bids must be labeled “**Metra Skybox Renovation**”. Bids may either be mailed or physically delivered to the following addresses.

Mail To:

Yellowstone County BOCC
PO Box 35000
Billings, MT 59107

Physically Deliver To:

Yellowstone County BOCC
City Hall Building, Room 3101, 3rd Floor
316 North 26th Street
Billings, MT 59101

All bids must be received no later than 3:00 PM on Monday, November 24th, 2025. Bids received after this deadline will not be considered.

All bids must include a Bid Security made in favor of Yellowstone County in an amount equal to 10% of the total bid. The security may consist of a bid bond, cash, a cashier’s check, a certified check, a bank money order, a certificate of deposit, a money market certificate, or a bank draft. The security must be: a) drawn and issued by a federally

chartered or state chartered bank or savings and loan association that is insured by or for which insurance is administered by the Federal Deposit Insurance Corporation; or b) drawn and issued by a credit union insured by the National Credit Union Share Insurance Fund; or c) a bid bond or bonds, original only, no photocopies, executed by a surety company authorized to do business in the State of Montana. Facsimiles, personal and/or business checks are not an acceptable form of security.

Timely bids will be opened and read aloud at 9:00 AM, on Tuesday, November 25th, in Room 3108 on the 3rd Floor of the City Hall Building, 316 North 26th Street, Billings, MT 59101.

3. Timeline & Selection Process

Event	Date/Time
Publication Dates for IFB	Friday, October 24 th , 2025 Friday, November 7 th , 2025
Mandatory Pre-Bid Meeting	Wednesday, November 12 th , 2025, at 2:00PM
Deadline for Bids	Monday, November 24 th , 2025 by 3:00 PM
Bid Opening	Tuesday, November 25 th , 2025, at 9:00 AM
Review of Bids by Selection Committee	Week of December 1 st , 2025
Notice of Intent to Award Posting	Tuesday, December 9 th , 2025
Notice of Award	Tuesday, December 16 th , 2025

Yellowstone County reserves the right to modify the above timeline as needed.

A selection committee will be formed and review all bids that meet the submittal requirements. The committee will review to ensure that minimum specifications are clearly met and make a recommendation of award which will be submitted to the BOCC. Bids that do not meet minimum specifications provided will be considered non-responsive.

The Board of County Commissioners intend to award the contract to the lowest responsive and best responsible bid. The Board reserves the right to reject any or all bids received, to waive informalities to evaluate the bids submitted, and to accept the bid that best serves the interests of Yellowstone County.

4. Amendments to Solicitation

Any interpretation, correction, or addition of this request will be published on the County website at <https://www.yellowstonecountymt.gov/purchasing/>.

5. Contact Information & Questions

Any questions regarding the project or bid submittal procedures should be submitted, in writing, to Matt Kessler, Purchasing Agent, at mkessler@yellowstonecountymt.gov.

6. Miscellaneous

Compliance With Laws

Each bidder must have a current Montana Public Contractor's Registration number when submitting their bid. The number must appear on the bid. All subcontractors, if any, must obtain a registration number prior to beginning any work on the project. Bid only registrations are acceptable for the bidding process. No bid may be withdrawn for at least 45 days after the scheduled deadline time for receipt of the bids.

The successful bidder will be required to follow all the directives included in section 18-2-422 of the Montana Code Annotated concerning Montana Prevailing Wages for Building Construction 2025. Those directives are as follows:

- (1) The contractor and employers shall pay the standard prevailing wage rate, including fringe benefits, for each job classification as stated in the current prevailing wage rate schedules. The current schedules are available at the State of Montana website. It is the responsibility of the contractors to obtain and use the applicable Wage Rate Schedules.
- (2) each contractor and employer are required to maintain payroll records in a manner readily capable of being certified for submission under statute 18-2-423, for not less than 3 years after the contractor's or employer's completion of work on the project; and
- (3) Each contractor is required to post a statement of all wages and fringe benefits in compliance with 18-2-423.

Statute 18-2-423 is as follows: If a complaint is filed with the department alleging noncompliance with 18-2-422, the department may require the project to submit to it certified copies of the payroll records for workers employed on that project. A contractor or a subcontractor shall pay employees receiving an hourly wage on a weekly basis. If a wage violation complaint is filed with the department, the contractor or subcontractor shall provide the employee's payroll records to the department within 5 days of receiving the payroll request from the department.

The Contractor is required to comply with all other applicable provisions of Title 18, Chapter 2, and Part 4 of the Montana Code Annotated.

The successful bidder will be required to give preference to the employment of bona fide Montana residents in the performance of the work on this project.

The Contractor must, in performance of work under this contract, fully comply with all applicable federal, state or local laws, rules, and regulations, including the Montana Human Rights Act, Civil Rights Act of 1964, the Age Discrimination Act of 1975, and the American with Disabilities Act of 1990. Any subletting or subcontracting by the Contractor subjects Subcontractors to the same provisions. In accordance with Section 49-3-207, MCA, the Contractor agrees that the hiring of persons to perform the contract will be made on the basis of merit and qualifications and there will be no discrimination based upon race, color, religion, creed, political ideas, sex, age, marital status, physical or mental disability, or national origin by the persons performing under the contract.

Insurance Requirements

The Contractor shall maintain at its sole cost and expense, commercial general liability insurance naming Yellowstone County/MetraPark, as additional insured for this project against liability for damages for bodily injury, including death and completed operations and property damages in a minimum amount of Seven Hundred Fifty Thousand Dollars (\$750,000.00) for each claim and One Million Five Hundred Thousand Dollars , (\$1,500,000.00), in the aggregate arising from incidents which occur as the result of Contractors negligence during the project and for which Yellowstone County/MetraPark, sole basis of liability is vicarious liability for the acts or omissions of the Contractor or/and subcontractors. Contractor shall maintain for this project at its cost and expense, insurance against claims for injuries to persons or damages to property, including contractual liability which may arise from or in connection with the project by Contractor, agents, employees, representatives, assigns and sub-contractors. This insurance shall cover claims as may be caused by any negligent act or omission. The policy of insurance shall be an occurrence policy with a Best Rating of A- or better and must be in force throughout the project.

Contractor shall name on the Certificate of liability insurance Yellowstone County, as additional insured throughout the project. In addition, Contractor will furnish to Yellowstone County, a copy of the policy endorsement, CG 32 87 05 10, indicating that Yellowstone County/MetraPark, are named as an additional insured under the Contractors insurance policy for this project. Contractor agrees to furnish both the Certificate of insurance and policy endorsement at least ten (10) days prior to beginning work on the project.

Contractor agrees to defend, indemnify and hold harmless Yellowstone County/MetraPark, from and against any and all claims demands, obligations causes of action, lawsuits and all damages and liabilities fines, judgments, costs, (including settlement costs), and expenses associated there with (including reasonable attorney's fees and disbursements), arising from incidents that occur the result of Contractors negligence during this project. And for which Yellowstone County/MetraPark, sole basis of liability is vicarious liability for the acts or omissions of Contractor. The defense and indemnification obligations under this paragraph shall not be limited by any assertions or finding that Yellowstone County, is liable for any damages by reason of a non-delegable duty.

The Board of County Commissioners intend to award the contract to the lowest responsive and responsible bid. The Board reserves the right to reject any or all bids received, to waive informalities to evaluate the bids submitted, and to accept the bid that best serves the interests of Yellowstone County.

Board of County Commissioners
Yellowstone County, Montana

Mark Morse
Chair

Attest:

Jeff Martin
Clerk and Recorder

MetraPark Skybox Renovation

Bid Sheet

Use this bid sheet to provide bid information. Along with this sheet, please include a detailed Schedule of Values document breaking down the total bid amount for County review. Details on ALT #1 – 4 are found on the cover sheet (G001) of Exhibit A – Construction Documents.

Vendor: _____

Base Bid Amount: \$ _____

Written Amount: _____

ALT #1: _____

ALT #2: _____

ALT #3: _____

ALT #4: _____

Estimated Start Date*: _____

Expected Completion Date: _____

* Please use December 16th as the earliest possible start date. This is the scheduled date of award but may be subject to change.

CHECK LIST

Please be sure you have completed the following prior to submitting your bid.

1. Read and understand the specifications.
2. Made yourself familiar with any State laws that pertain to the bid
3. Asked and received any answers to any questions regarding the bid procedure, specifications or general information.
4. Addressed and mailed or delivered your bid to be received at the correct address by the time and date indicated in the Invitation to Bid.

- END OF IFB -

10.22.2025

308 6TH AVE N, BILLINGS MT, 59101
YELLOWSTONE COUNTY

METRAPARK SKYBOX REFRESH

CONSTRUCTION DOCUMENTS

OWNER
MetraPark
308 6th Ave N
Billings, MT 59101

ARCHITECT/ENGINEER
Cushing Terrell
13 N. 23rd Street
Billings, MT 59101
406.896.6118
Contact: Dawn Mackenzie

ELECTRICAL
Cushing Terrell
13 N. 23rd Street
Billings, MT 59101
406.896.6157
Contact: Sarah Restad

PROJECT ADDRESS
308 6th Ave N
Billings, MT 59101

VICINITY MAP: Locator 



SHEET INDEX

- GENERAL
- G001 COVER SHEET, GENERAL INFORMATION
- ARCHITECTURAL
- A501 FINISH PLANS, SCHEDULES, ELEVATIONS & DETAILS
- ELECTRICAL
- E001 LEGENDS AND GENERAL NOTES
- E002 ELECTRICAL SPECIFICATIONS
- E202 LIGHTING PLANS

ADD ALTERNATE

- A1. ADD ALTERNATE #1: FINISH STAIRS AND LANDING WITH RUBBER TREADS, RISERS - SEE 'STR1'. PAINT EXISTING STRINGERS 'P2'. GC TO CONFIRM PRIOR TO START OF CONSTRUCTION IF INCLUDED IN THIS PROJECT
- A2. ADD ALTERNATE #2: PAINT EXISTING CABINETS 'P4'. LEAVE COUNTERTOP EXISTING. GC TO CONFIRM PRIOR TO START OF CONSTRUCTION IF INCLUDED IN THIS PROJECT
- A3. ADD ALTERNATE #3: 'F1' FLOORING IN CORRIDOR AND LOBBY. REUSE EXISTING BASE, DO NOT PAINT GC TO CONFIRM PRIOR TO START OF CONSTRUCTION IF INCLUDED IN THIS PROJECT.
- A4. ADD ALTERNATE #4: REPLACE CEILING GRID IN LIEU OF PAINTING CEILING GRID. GC TO CONFIRM PRIOR TO START OF CONSTRUCTION IF INCLUDED IN THIS PROJECT.

308 6TH AVE N, BILLINGS MT, 59101
YELLOWSTONE COUNTY
METRAPARK SKYBOX REFRESH

© 2025 | ALL RIGHTS RESERVED

CONSTRUCTION DOCUMENTS

10.22.2025
PROJ# | YC25_METBOX
DESIGNED BY | MACKENZIE
DRAWN BY | WISCOMB
REVIEWED BY | MACKENZIE
REVISIONS

COVER SHEET,
GENERAL
INFORMATION

G001

GENERAL DEMOLITION NOTES

- REFERENCE ELECTRICAL DRAWINGS FOR ADDITIONAL DEMOLITION REQUIREMENTS.
- PROTECT ALL EXISTING ELECTRICAL AND MECHANICAL, ANY OTHER EQUIPMENT, COVERS, AND WIRING, ETC. TO REMAIN. REPLACE ANY DAMAGED ITEM WITH NEW TO MATCH EXISTING.
- VERIFY ALL EXISTING CONDITIONS AND COORDINATE ALL DEMOLITION WITH NEW CONSTRUCTION.
- WHETHER SPECIFICALLY INDICATED OR NOT, REMOVE PORTION OF EXISTING CONSTRUCTION AS REQUIRED TO COMPLETE WORK INDICATED AND PREP EXISTING CONSTRUCTION TO REMAIN FOR NEW CONSTRUCTION.
- EXPECT TO CAREFULLY REMOVE OR DISASSEMBLE VARIOUS ITEMS SO ADJACENT ITEMS AND FINISHES THAT ARE EXISTING TO REMAIN ARE NOT DAMAGED. PROPERLY REPAIR/REPLACE DAMAGED ITEMS AND FINISHES WITH NEW TO MATCH EXISTING.
- COORDINATE WITH OWNER FOR ANY REMOVED OR DEMOLISHED ITEMS TO BE RETURNED TO THE OWNER.

FINISH PLAN LEGEND

NAME
101 ROOM NAME AND NUMBER

AS## # INTERIOR ELEVATION CALLOUT AND DIRECTION OF ELEVATION VIEW

XXX## FINISH TAG

XX##/## EXTENT OF ACCENT PAINT OR WALL FINISHES

FINISH TAGS DISPLAYED IN GROUPING ON FINISH PLAN REPRESENT MAJORITY ROOM FINISH SELECTIONS. ORDER OF GROUPING DEFINED IN EXAMPLE BELOW:

- XXX## MAJORITY WALL FINISH
- XX##/## MAJORITY BASE FINISH
- XX## MAJORITY FLOOR FINISH

RT1 FLOOR FINISH 'RT1'

RT1' FLOOR FINISH 'RT1' (SEE KEYNOTE 'A3')

EX1 FLOOR FINISH 'EX1'

NOT IN SCOPE

GENERAL FINISH NOTES

- VERIFY ALL CONDITIONS AND DIMENSIONS IN FIELD. EXISTING CONDITIONS OF WINDOWS AND OTHER BUILDING ELEMENTS MAY VARY. IF MEASUREMENTS IN FIELD DEVIATE FROM THE DIMENSIONS SHOWN WITHIN THESE DOCUMENTS BY GREATER THAN 6" OR AFFECT DESIGN INTENT COORDINATE AND NOTIFY THE PROJECT ARCHITECT PRIOR TO CONTINUING WORK.
- FIELD VERIFY ALL DIMENSIONS PRIOR TO FABRICATION.
- ALL PRODUCTS ARE TO BE INSTALLED PER MANUFACTURER'S INSTRUCTIONS, USING MANUFACTURER'S ADHESIVES, TOOLS, AND METHODS.
- REFER TO SPECIFICATIONS FOR ALL FINISH MATERIAL PRODUCT INFORMATION.
- COORDINATE ALL OWNER FURNISHED EQUIPMENT, ACCESSORIES, AND FURNITURE WITH OWNER AND/OR OWNER'S VENDOR.
- ALL FLOOR TRANSITIONS ARE TO OCCUR DIRECTLY BENEATH DOORS OR CENTERED IN OPENING UNLESS NOTED OTHERWISE.
- ALL FLOOR TRANSITIONS ARE TO BE ADA COMPLIANT.
- ALL GYPSUM WALLS TO BE PAINTED UNLESS OTHERWISE NOTED.
- ALL CEILINGS IN SUITES 1-10 TO BE 'AC1' UNLESS OTHERWISE NOTED.
- ALL METAL ACCESS PANELS, COVER PLATES, VENTS, AND GRILLES TO BE PAINTED TO MATCH THE SURFACE IT IS LOCATED ON.
- ALL PLASTIC LAMINATE COUNTERTOPS ARE TO BE 'PL1' WITH 1.5" BEVELED EDGE.
- ALL PAINTED SURFACES TO RECEIVE A MINIMUM OF ONE COAT PRIMER, TWO FINISH COATS. USE PRIMERS RECOMMENDED FOR EACH SUBSTRATE. FINISH COATS AS FOLLOWS: CONCRETE, MASONRY AND DRYWALL - SHERWIN WILLIAMS PROMAR 200, EG-SHEL FINISH. METAL TRIM - SHERWIN WILLIAMS PRO INDUSTRIAL ACRYLIC, SEMI-GLOSS FINISH. METAL CEILING GRID TO HAVE EG-SHEL FINISH. WOOD - SHERWIN WILLIAMS SCUFF TUFF INTERIOR WATERBASED ENAMEL, SEMI-GLOSS FINISH.
- BASIS OF DESIGN LISTED. ALTERNATE MATERIALS NEED PRIOR APPROVAL BY ARCHITECT AND OWNER.

KEYNOTES

- HANDRAILS IN THIS ROOM TO BE PAINTED 'P3'
- REMOVE EXISTING CEILING TILES, REPLACE WITH 'AC1'. PAINT EXISTING GRID 'P5'.
- GC TO DETERMINE 'TR2' PROFILE REQUIRED TO ACCOMMODATE EXISTING FLOORING.
- USE 'TR1' AT STAIR NOSING.
- MODIFY BAR TO BE 30" H. REUSE EXISTING COUNTERTOP
- CREATE SOLID SURFACE SILL 'SS1' CAP AT WINDOW.
- USE 'TR1' NOSING AT TOP STAIR ONLY.
- EXISTING BUILT IN BAR TO REMAIN.
- PATCH AND REPAIR WALL AS NEEDED.
- ADD ALTERNATE #1: FINISH STAIRS AND LANDING WITH RUBBER TREADS, RISERS - SEE 'STR1'. PAINT EXISTING STRINGERS 'P2'. GC TO CONFIRM PRIOR TO START OF CONSTRUCTION IF INCLUDED IN THIS PROJECT.
- ADD ALTERNATE #2: PAINT EXISTING CABINETS 'P4'. LEAVE COUNTERTOP EXISTING. GC TO CONFIRM PRIOR TO START OF CONSTRUCTION IF INCLUDED IN THIS PROJECT.
- ADD ALTERNATE #3: 'FT1' FLOORING IN CORRIDOR AND LOBBY. REUSE EXISTING BASE. DO NOT PAINT. GC TO CONFIRM PRIOR TO START OF CONSTRUCTION IF INCLUDED IN THIS PROJECT.
- ADD ALTERNATE #4: REPLACE CEILING GRID IN LIEU OF PAINTING CEILING GRID. GC TO CONFIRM PRIOR TO START OF CONSTRUCTION IF INCLUDED IN THIS PROJECT.

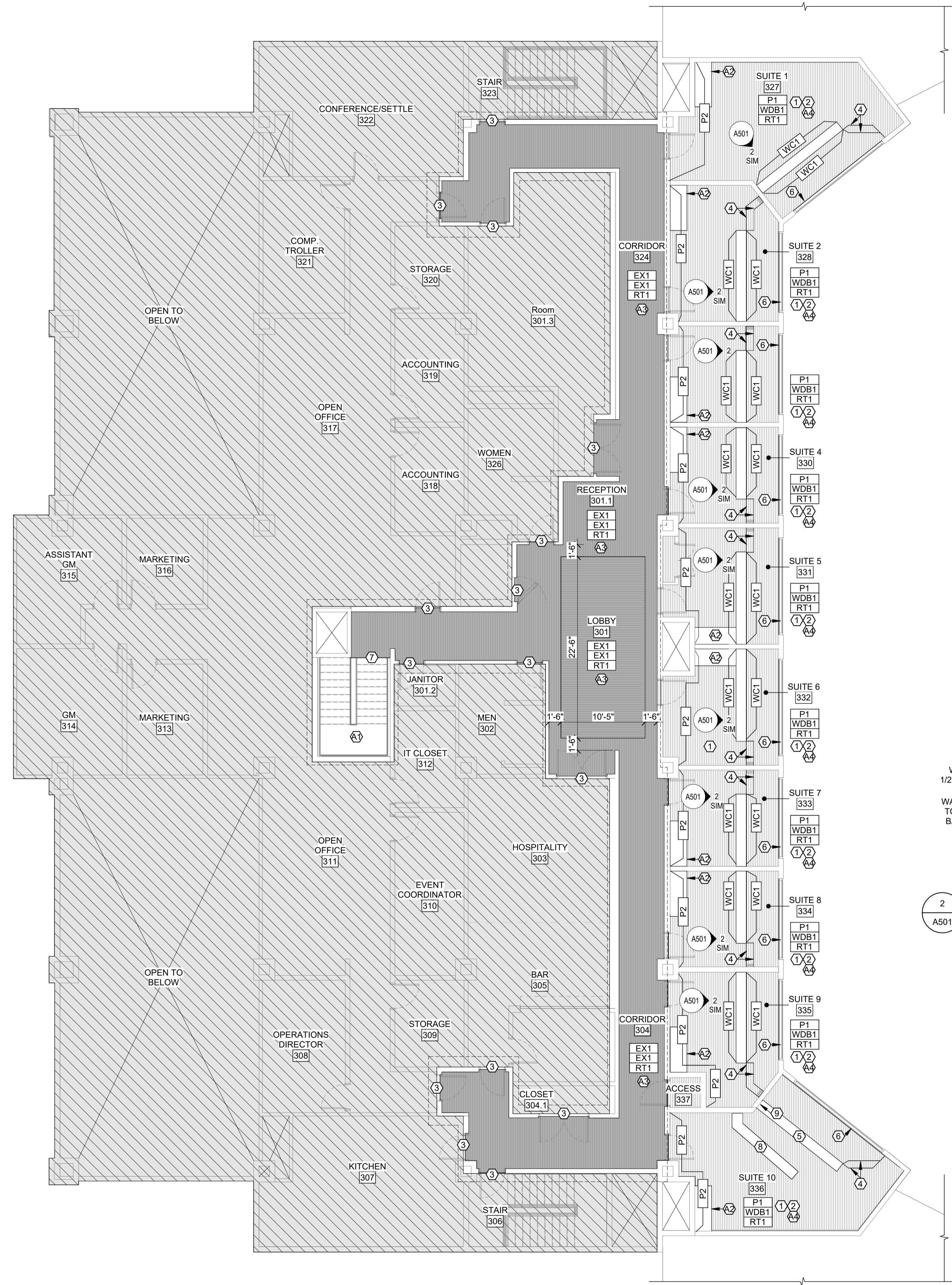

2 TYPICAL SUITE - EAST
1/4" = 1'-0"

3 TYPICAL BAR COUNTER DETAIL
1" = 1'-0"

ITEM NO	PRODUCT TYPE	MANUFACTURER	DESCRIPTION	COLOR	SIZE	NOTES
BASE						
WDB1	WOOD BASE		PAINTE EXISTING BASE 'P4'			
CEILING						
AC1	ACOUSTIC CEILING	ARMSTRONG	FINE-FISSURED HIGH NRC-1755	BL-TECH BLACK	2' X 4' X 7/8"	
FLOOR						
RT1	RESILIENT FLOORING	PATCRAFT	REMOVE 1417V	NEUTRAL MIX 00550	12" X 24", 5 MM THICK	BIRCK INSTALLATION METHOD. GLUE DOWN WITH MANUFACTURER'S RECOMMENDED ADHESIVE.
GENERAL						
EX1	EXISTING TO REMAIN					
MILLWORK						
PL1	PLASTIC LAMINATE SOLID SURFACE	FORMICA CORIAN	USED AT WINDOW SILL	TINTED PAPER TERRAZZO 8812 DOVE	3" x 3" X 1/2" THICKNESS	90 DEGREE SILL WITH EASED EDGES
TRANSITIONS						
STR1	STAIR COMPONENTS (ALL NOSING, TREAD, RISER)	JOHNSONITE	ANGLEFIT RUBBER STAIR TREADS W/ INTEGRATED RISER FOR THE VISUALLY IMPAIRED	71-STORM CLOUD	SIZE AND NOSING PROFILE REQUIRED FOR COMPLETE INSTALLATION	INSTALL MATCHING RUBBER FLOOR TILES AT LANDING
TR1	TRANSITION PROFILE	FUTURA	LVT 341 NO LIP STAIR NOSING	ETCHED ALUMINUM	5MM LVT FOR OUTSIDE STAIR NOSE	
TR2	TRANSITION PROFILE	JOHNSONITE	SLIMLINE REDUCER STRIP	71-STORM CLOUD		SEE DRAWINGS
WALL						
P1	PAINT	SHERWIN WILLIAMS	TYPICAL WALL PAINT	BEDROCK 9563		
P2	PAINT	SHERWIN WILLIAMS	ACCENT WALL PAINT	OUTERSPACE 6251		
P3	PAINT	SHERWIN WILLIAMS	HANDRAIL PAINT	MINDFUL GRAY 7016		
P4	PAINT	SHERWIN WILLIAMS	BASE, CABINET, WOOD CAP PAINT	CITYSCAPE 7067		
P5	PAINT	SHERWIN WILLIAMS	METAL GRID PAINT	INKWELL 6992		
WC1	WALLCOVERING	MOMENTUM	TRANQUILITY WC	LEAD 2ATR-32	54" W X 3/16" THICK	INSTALLATION METHOD: NON-REVERSE HANG. RANDOM MATCH. NO REPEAT.

1 SECOND FLOOR FINISH PLAN
1/8" = 1'-0"

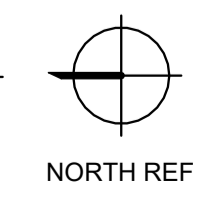

308 6TH AVE N, BILLINGS MT, 59101
YELLOWSTONE COUNTY
METRAPARK SKYBOX REFRESH

© 2025 | ALL RIGHTS RESERVED

CONSTRUCTION DOCUMENTS

10.22.2025
PROJ# | YC25_METBOX
DESIGNED BY | MACKENZIE
DRAWN BY | WISCOMB
REVIEWED BY | MACKENZIE
REVISIONS

FINISH PLANS, SCHEDULES, ELEVATIONS & DETAILS

A501

COMMON WORK GENERAL NOTES

- COMPLY WITH THE LATEST ADOPTED VERSION OF NEC, ENERGY CODE, AND ANY OTHER LOCAL CODES/STANDARDS.
- REFER TO AND COMPLY WITH DETAILS LISTED IN THE PROJECT SPECIFICATIONS DOCUMENT.
- ITEMS SHOWN IN LIGHT LINE WEIGHT ARE EXISTING TO REMAIN, UNLESS NOTED OTHERWISE. ITEMS SHOWN IN HEAVY LINEWEIGHT ON NEW PLANS, ARE ALL NEW OR RELOCATED UNLESS NOTED OTHERWISE.
- ELECTRICAL DRAWINGS ARE DIAGRAMMATIC IN NATURE. ELECTRICAL CONTRACTOR SHALL COORDINATE ALL ELECTRICAL EQUIPMENT AND DEVICE LOCATIONS WITH ARCHITECTURAL, MECHANICAL, AND PLUMBING DIVISIONS PRIOR TO ROUGH-IN. REFER TO AND COORDINATE WITH ARCHITECTURAL, MECHANICAL, AND PLUMBING DRAWINGS FOR ADDITIONAL WORK THAT IS REQUIRED BY THE ELECTRICAL CONTRACTOR.
- INFORMATION ON DRAWINGS HAS BEEN ASCERTAINED FROM EXISTING DRAWINGS AND/OR FIELD OBSERVATIONS. THIS INFORMATION IS AS ACCURATE AS CONDITIONS WOULD ALLOW. IT IS THE RESPONSIBILITY OF THE CONTRACTOR TO VISIT THE SITE, PRIOR TO BID, AND BECOME FAMILIAR WITH THE EXTENT OF THE WORK REQUIRED. NO EXTRAS WILL BE ALLOWED FOR ALTERATIONS OF A FORESEEABLE NATURE REQUIRED TO ACHIEVE THE END RESULT AS INDICATED BY CONTRACT DOCUMENTS.
- ANY ITEMS DAMAGED BY THE CONTRACTOR SHALL BE REPLACED BY THE CONTRACTOR, AT NO ADDITIONAL COST TO THE OWNER.
- REFER TO SPECIFICATION 260533 FOR EXPOSED AND CONCEALED RACEWAY REQUIREMENTS.
- ALL WORK REQUIRING BUILDING SHUTDOWN TO EXISTING AND OPERATING PORTIONS OF THE BUILDING SHALL BE COORDINATED IN WRITING WITH BUILDING OWNERS' REPRESENTATIVE MINIMUM 10-DAYS PRIOR TO SHUTDOWN.
- ELECTRICAL CONTRACTOR SHALL MAINTAIN FIRE RATINGS FOR ALL CONDUIT AND BOX PENETRATIONS THROUGH FIRE-RATED CONSTRUCTION. SEAL ALL PENETRATIONS OF RATED WALLS PER SPECIFICATIONS. SEE ARCHITECTURAL DRAWINGS FOR WALL RATINGS AND LOCATIONS.
- COORDINATE PATHWAYS AND LOCATIONS OF ALL DEVICES INSTALLED WITHIN CASEWORK WITH SHOP DRAWINGS PRIOR TO ROUGH-IN AND INSTALLATION.
- CONTRACTOR SHALL NOT ROUTE ANY CONDUIT WITHIN STRUCTURAL MEMBERS OR STRUCTURAL TOPPING SLABS OF FLOORS, UNLESS NOTED OTHERWISE AND COORDINATED WITH STRUCTURAL. DRAWINGS INDICATE GENERAL DIRECTIONS AND ROUTES. FIELD COORDINATE EXACT ROUTE AND INSTALLATION OF CONDUIT WITH CONDITIONS OF CONSTRUCTION.
- REFER TO ARCHITECTURAL ELEVATIONS FOR OUTLET HEIGHTS WHERE THE SPECIFIC OUTLET HEIGHT IS NOT INDICATED ON THE DRAWING. REFER TO THE ELECTRICAL LEGEND FOR THE DEFAULT. OUTLET HEIGHT WHEN NOT INDICATED ON ELEVATIONS OR ON THIS SHEET.
- ADA COMPLIANCE: ELECTRICAL DEVICES PROJECTING FROM WALLS WITH THEIR LEADING EDGES BETWEEN 27" AND 80" AFF SHALL PROTRUDE NO MORE THAN 4" INTO WALKS OR CORRIDORS.
- ALL SPARE CONDUITS SHALL CONTAIN A PULL CORD. EACH END OF THE CONDUIT SHALL HAVE A LABEL IDENTIFYING THE TERMINATION POINT OF THE OPPOSITE END OF THE CONDUIT.
- CONTRACTOR IS RESPONSIBLE FOR LOCATING ALL EXISTING UNDERGROUND UTILITIES PRIOR TO EXCAVATION. ANY DAMAGE TO THE EXISTING UTILITY SHALL BE REPAIRED AT THE CONTRACTOR'S EXPENSE.
- CONTRACTOR IS RESPONSIBLE FOR ALL TRENCHING, PATCHING, EXCAVATION, BACKFILL, AND RESTORATION RELATED TO THEIR WORK.

DEMOLITION GENERAL NOTES

- OWNER SHALL HAVE FIRST RIGHT OF REFUSAL OF ALL EQUIPMENT, FIXTURES, DEVICES, ETC. WHICH ARE INDICATED TO BE REMOVED.
- CONTRACTOR SHALL BE RESPONSIBLE FOR ALL FIXTURES INDICATED TO BE REUSED OR RELOCATED AND SHALL PROTECT ALL ITEMS FOR THE DURATION OF CONSTRUCTION. ANY ITEMS DAMAGED OR RUINED DURING STORAGE SHALL BE REPLACED BY THE CONTRACTOR AT NO ADDITIONAL COST.
- ELECTRICAL WORK IS THE RESPONSIBILITY OF THE ELECTRICAL CONTRACTOR. PATCHING AND PAINTING IS THE RESPONSIBILITY OF THE GENERAL CONTRACTOR.
- DISCONNECT ALL ELECTRICAL ITEMS WHICH ARE TO BE REMOVED AND/OR RELOCATED WHILE MAINTAINING CONTINUITY OF REMAINING CIRCUITRY.
- PROVIDE NEW CONDUCTORS, RACEWAYS, ETC., AS REQUIRED TO MAINTAIN OPERATION OF EXISTING OUTLETS, EQUIPMENT, ETC. WHICH REMAIN OR ARE RELOCATED.
- NO EXISTING WIRING MAY BE REUSED IN THE NEW ELECTRICAL WORK UNLESS OTHERWISE NOTED.
- ALL EXISTING CIRCUITS, CONDUIT AND WIRE THAT ARE NOT IN USE AFTER DEMOLITION IS COMPLETED SHALL BE REMOVED.
- EXISTING CONDUITS IN THE FLOOR WHICH ARE NOT USED AND WHICH ARE ABANDONED SHALL BE TRIMMED TO FLOOR SURFACE, GROUND FLUSH AND FILLED WITH GROUT. FINISH FLOOR TO MATCH EXISTING.
- WORK SHALL BE PERFORMED WITH NO DISRUPTION OF THE OWNER'S BUSINESS. ALL ELECTRICAL POWER DISRUPTIONS SHALL BE SCHEDULED AND APPROVED BY THE OWNER.
- ALL DASHED ITEMS ON DEMOLITION PLANS ARE TO BE REMOVED UNLESS NOTED OTHERWISE. SOLID ITEMS ARE TO REMAIN OR TO BE RELOCATED AS NOTED. NOTE - ITEMS SHOWN IN THE DEMOLITION PLANS ARE BASED ON FIELD OBSERVATIONS. ADDITIONAL ELECTRICAL ITEMS MAY BE ENCOUNTERED THAT ARE NOT SHOWN - ALL GENERAL ELECTRICAL ITEMS ARE TO BE REMOVED THAT ARE NOT SHOWN BUT ARE IN AREAS OF COMPLETE REMODEL.

LIGHTING GENERAL NOTES

- LIGHTING CONTROLS MANUFACTURER SHALL PROVIDE SHOP DRAWINGS INDICATING ALL REQUIRED CONNECTIONS FOR RESPECTIVE MANUFACTURER'S SYSTEM. PROVIDE ALL LIGHTING CONTROLS CONNECTIONS IN ACCORDANCE WITH MANUFACTURER'S SHOP DRAWINGS.
- LOW VOLTAGE WIRING IS NOT DEPICTED ON PLAN DIAGRAMS. REFER TO MANUFACTURER'S CONNECTION DIAGRAMS FOR LOW VOLTAGE REQUIREMENTS. ALL LOW VOLTAGE CABLE IS TO BE PLENUM RATED.
- CONTRACTORS WORK SHALL INCLUDE ALL LABOR, MATERIALS, AND EQUIPMENT REQUIRED FOR A COMPLETE AND OPERATIONAL SYSTEM.
- WHERE OCCUPANCY SENSORS ARE SHOWN, THE MANUFACTURER SHALL PROVIDE ADEQUATE QUANTITY OF SENSORS BASED ON SPECIFIC MANUFACTURER SENSOR COVERAGE.
- FIELD VERIFY EXACT LOCATION OF EACH SENSOR. LOCATE PER MANUFACTURER'S RECOMMENDATIONS. ULTRASONIC SENSORS SHALL BE INSTALLED A MINIMUM OF 5FT FROM ANY HVAC SUPPLY OR RETURN AIR DIFFUSER.
- PROVIDE TRAINING FOR OWNER'S MAINTENANCE PERSONNEL AND DEVICE ADJUSTMENT AS REQUIRED IN SPECIFICATION 260923.
- ALL EXIT LIGHTS AND EMERGENCY SENSING LEGS FOR EMERGENCY FIXTURES SHALL BE CONNECTED AHEAD OF SWITCH LEG FOR THE LOCAL AREA CIRCUIT. WHERE MULTIPLE CIRCUITS EXIST WITHIN A SPACE, LOCAL AREA CIRCUIT SHALL BE DEFINED AS GENERAL AREA LIGHTING CIRCUIT, UNLESS NOTED OTHERWISE.

ELECTRICAL LEGEND

LIGHTING

SYMBOL	DESCRIPTION
	LAY-IN OR RECESSED FIXTURE, SIZE ON PLANS
	RECESSED DOWNLIGHT FIXTURE
	LIGHT SWITCH SUBSCRIPT: D - DIMMING SWITCH

ABBREVIATIONS AND MISCELLANEOUS

SYMBOL	DESCRIPTION
AC	ABOVE COUNTER, 4" BACK SPLASH
ATS	AUTOMATIC TRANSFER SWITCH
AFG	ABOVE FINISHED GRADE
AFF	ABOVE FINISHED FLOOR
AL	ALUMINUM
BLG	BELOW GRADE
BOD	BOTTOM OF DEVICE
C	CONDUIT
CLG	CEILING
COD	CENTER OF DEVICE
CU	COPPER
(D)	DEMO
(E)	EXISTING
EC	ELECTRICAL CONTRACTOR
GC	GENERAL CONTRACTOR
GND	GROUND
LSI	FIELD ADJUSTABLE LONG TIME, SHORT TIME AND INSTANTANEOUS
LSIG	FIELD ADJUSTABLE LONG TIME, SHORT TIME, INSTANTANEOUS AND GROUND FAULT
MC	MECHANICAL CONTRACTOR
(N)	NEW
NL	NIGHT LIGHT
QTY	QUANTITY
(R)	RELOCATED
SF	SURFACE
TC	TEMPERATURE CONTROL CONTRACTOR
TTB	TELEPHONE TERMINAL BOARD
TYP	TYPICAL
UG	UNDERGROUND
W	WITH
WM	WIRE MOLD
WP	WEATHER PROOF (WHILE IN USE)
XFMR	TRANSFORMER
a.b.c etc	SWITCH DESIGNATION
BN1L-2.4.6	CIRCUIT DESIGNATION, PANEL BN1L, CIRCUITS 2,4,6
1/E501	INDICATES DETAIL 1 ON SHEET E501
#	SHEET WORK NOTE
#	SHEET DEMO WORK NOTE
	HOME RUN TO PANEL
	CONDUIT CONCEALED IN CEILING OR WALL
	CONDUIT CONCEALED UNDER FLOOR OR GRADE
	LOW VOLTAGE CIRCUIT
	FIBER OPTIC CABLE
	CABLE TRAY
	CIRCUIT, NUMBER OF HASH MARKS INDICATES NUMBER OF CONDUCTORS IN CABLE/RACEWAY. GROUND WIRE IS NOT SHOWN BUT SHALL BE INCLUDED. NO HASH MARKS INDICATES 2 CONDUCTORS PLUS GROUND.

INTERIOR BOX MOUNTING HEIGHTS

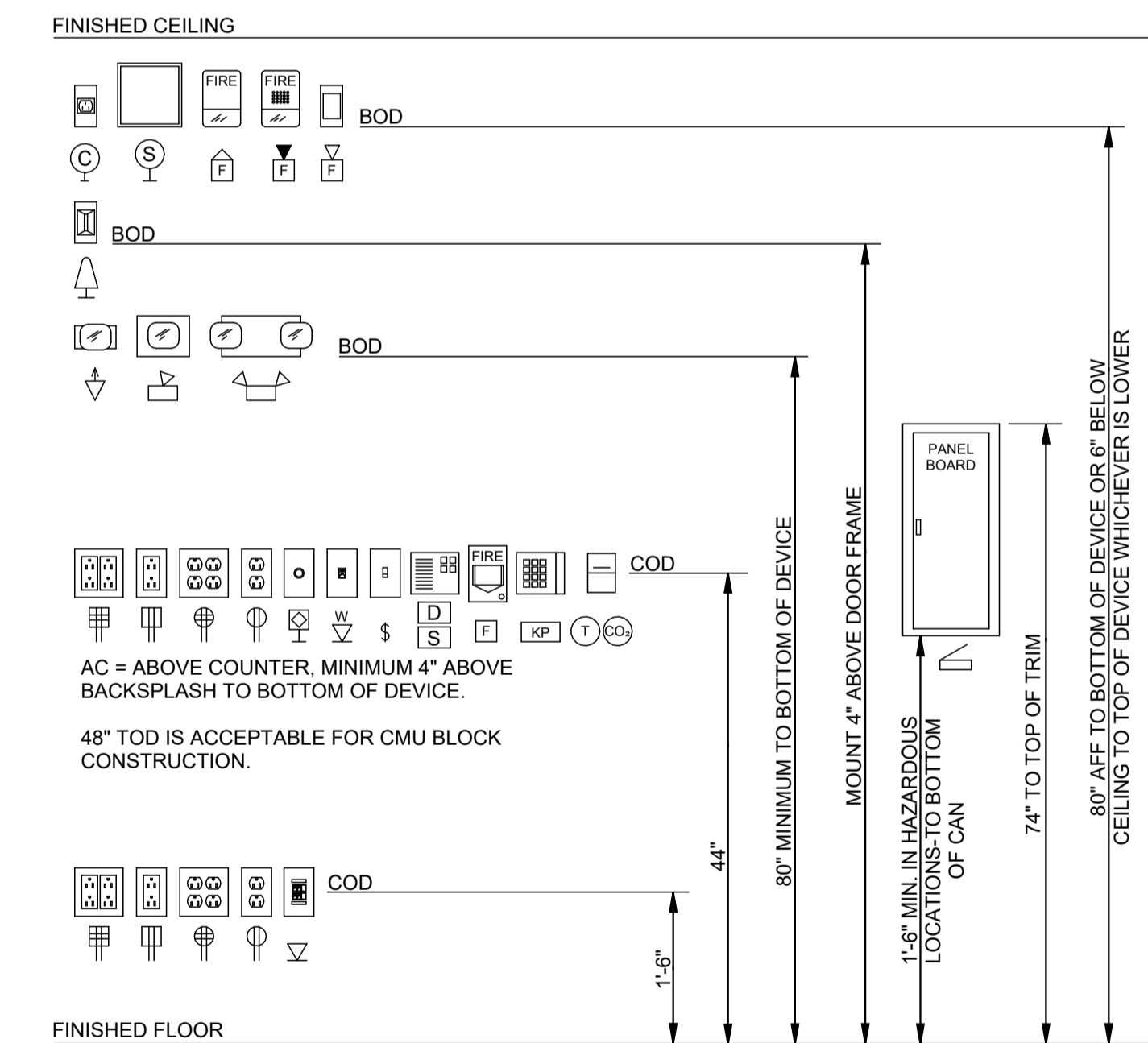

LIGHTING FIXTURE SCHEDULE															
TYPE	DESCRIPTION	MANUFACTURER	FIXTURE			MOUNTING			LIGHT SOURCE			OPTIONS		NOTES	
			CATALOG NUMBER	ENERGY LISTING	LOCATION	TYPE	HEIGHT	VOLTAGE	VA	FINISH	CRI	KELVIN	LUMENS		DIMMABLE
D1	6" DOWNLIGHTS	GOTHAM	IVO6 D 15LM 35K 90CRI WD MIN10 MVOLT ZT AR LSS F	ENERGY STAR	CEILING	RECESSED	-	120 V	15.00	SEMI SPECULAR	90	3500K	1500 lm	0-10V - 10% DIMMING	1

LIGHTING CONTROL EQUIPMENT SCHEDULE						
GENERAL NOTES: A. LOW VOLTAGE WIRING NOT DEPICTED ON PLAN DIAGRAMS. REFER TO MANUFACTURERS CONNECTION DIAGRAMS FOR LOW VOLTAGE REQUIREMENTS. B. ALL LOW-VOLTAGE CABLING AND CONTROLLERS SHALL BE PLENUM RATED. C. CONTRACTORS WORK TO INCLUDE ALL LABOR, MATERIALS, AND EQUIPMENT REQUIRED FOR A COMPLETE AND OPERATIONAL SYSTEM. D. FIELD VERIFY EXACT LOCATION OF EACH SENSOR. LOCATE PER MANUFACTURER'S RECOMMENDATIONS. ULTRASONIC SENSORS SHALL BE INSTALLED A MINIMUM OF 5FT FROM ANY HVAC SUPPLY OR RETURN AIR DIFFUSER. E. ALL CONTROLS SHALL BE FULLY ADJUSTED. ELECTRICAL CONTRACTOR TO PROVIDE TRAINING TO OWNER/MAINTENANCE STAFF FOR PROGRAMMING OF ALL LIGHTING CONTROLS IN PROJECT. F. ELECTRICAL CONTRACTOR TO PROVIDE FOLLOW UP AT 6 MONTHS AND 1 YEAR TO ADJUST LIGHTING AND LIGHTING CONTROLS AND PROVIDE ADDITIONAL TRAINING TO OWNER/MAINTENANCE STAFF IF REQUESTED.						
STANDARD SEQUENCE OF OPERATIONS: 1) NONE						
SYMBOL	SUBSCRIPT	MANUFACTURER	CATALOG NUMBER	VOLTAGE	MOUNTING HEIGHT	NOTES
§	D	SENSOR SWITCH	sPODMRA D BK	120 V	+44"	

ELECTRICAL SHEET INDEX

E001	LEGENDS AND GENERAL NOTES
E002	ELECTRICAL SPECIFICATIONS
E202	LIGHTING PLANS

Cushing Terrell.

cushingterrell.com
800.757.9522

308 6TH AVE N. BILLINGS MT. 59101
YELLOWSTONE COUNTY
METRAPARK SKYBOX REFRESH

© 2025 | ALL RIGHTS RESERVED

CONSTRUCTION DOCUMENTS

10.22.2025
PROJ# | YC25_METBOX
DESIGNED BY | RESTAD
DRAWN BY | RESTAD
REVIEWED BY | HAIDLE
REVISIONS

LEGENDS AND GENERAL NOTES

E001

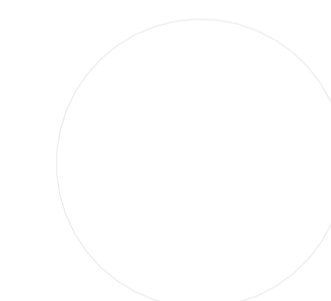

ELECTRICAL SPECIFICATIONS

DIVISION 26 - ELECTRICAL

SCOPE

The provisions, terms and requirements of Division 1 and 2, the applicable Drawings and Technical Specifications herein shall apply to work under this Division.

This Work consists of, but is not necessarily limited to, the furnishing of all labor, equipment, appliances and materials and the performance of all operations in connection with the installation of all electrical work completed, in strict accordance with Specifications and/or Drawings, applicable codes, including incidental materials necessary and required for their completion.

"PROVIDE" = Furnished and installed complete. "OR EQUAL" = Or equal as approved to quote by Engineer, 10 days prior to Bid via addendum.

260000 - COMMON WORK RESULTS

- A. Intent of Drawings: Drawings are partly diagrammatic and do not show exact location of conduit unless specifically dimensioned.
- B. Workmanship:
 - 1. Work shall be accomplished by workmen skilled in particular trade, in conformance with best practices and accepted standards.
 - 2. Work shall contribute to efficiency of operation, accessibility, maintenance and appearance. No part of installation shall interfere with operation of any other system or part of building.
 - 3. Non-satisfactory work shall be corrected at no additional expense to Owner.
- C. Responsibility:
 - 1. The Electrical Contractor is responsible for installation of satisfactory and complete work in accordance with the intent of Drawings and Specifications. Provide, at no extra cost, incidental items required for completion of work even though not specifically mentioned or indicated in Specifications or on Drawings.
 - 2. If, at any time, and in any case, change in location of conduit, outlets, fixtures, switches, panels, electrical equipment or associated components, etc., becomes necessary due to obstacles or installation of other trades, such required changes shall be made by Contractor at no extra cost.
 - 3. Conflicts discovered during construction shall be immediately called to the attention of the Engineer for decision. Do not proceed with installation in area of question until conflict has been fully resolved.
 - 4. Coordinate all electrical work with other trades to prevent unnecessary delays in the construction schedule.
 - 5. Excavation and backfill required by electrical installations shall be accomplished in accordance with Division 2 by this Contractor.
 - 6. Provide temporary electrical power and lighting for all trades that require service during the course of this Project. Provide temporary service and distribution as required. Comply with the NFPA 70 and OSHA requirements. (Energy costs by General Contractor.)
- D. Guarantee-Warranty: This Contractor shall and hereby does warrant and guarantee:
 - 1. That all work executed under this Section will be free from defects of materials and workmanship for a period of one year from the date of final acceptance of this work.
 - 2. The Contractor agrees to, at the Contractor's own expense, repair and replace all such defective materials and work and all other work damaged thereby which becomes defective during the term of warranty. Agreement does not include damages done by Owner.
- E. Permits, Tests, Codes and Standards:
 - 1. Electrical Contractor to pay for all permits and fees in connection with this work.
 - 2. WORK SHALL BE IN ACCORDANCE WITH THE MOST RECENT EDITIONS OF ADOPTED LOCAL, STATE AND NATIONAL CODES AND ORDINANCES, THE STATE FIRE MARSHAL, AND UTILITY COMPANY REGULATIONS.
 - 3. Electrical work shall conform to National Electrical Codes, latest editions, as a minimum requirement.
 - 4. All material to conform with applicable standards.
- F. Discrepancies: Prior to submitting Bid, Contractor shall refer any apparent discrepancies or omissions to engineer for clarification.
- G. Prior Approvals: All proposed substitutions shall be received by the Engineer **10 days prior to Bid. Priors received after 3 p.m. of the 10th day will be rejected.** Supply technical data, photometrics and dimensional Drawings showing that substitutes are equal to product specified.
- H. Shop Drawing Submittals:
 - 1. In addition to distribution requirements for submittals specified in Division 1 Section "Submittals" submit Electronic Drawings in pdf format for final and official approval through the General Contractor as listed below. **Provide pdf bookmark tabs for each type and section.** Provide separate pdf for each spec section; do not combine sections together unless they are 5 pages or less. If the Authority Having Jurisdiction requires Shop Drawings to have a Registered Engineers Stamp Affixed, this shall be the sole responsibility of the Contractor to acquire such stamp at Contractor's cost.

Additional copies may be required by individual Sections of these Specifications. Copies of price list sheets are not acceptable. Manufacturer's name and address must appear on each sheet. All copies shall be legible.

Shop Drawings shall include a completed specification sheet of all equipment along with fabrication, installation drawings, setting diagrams, schedules, patterns, templates and similar Drawings. Installation drawings for fire alarm shall be done with a computer cadd program and include no other system. A basic floor plan in pdf, electronic format can be obtained through the General Contractor. Autocad .dwg format will not be available.
- I. Project Close-Out Record Documents:
 - 1. Provide three full size sets, unless more are called for under Division 1 (one for Engineer and one for Owner). In addition to requirements called for under Division 1, indicate the following installed conditions:
 - a. Actual location of all electrical service gear/feeders, panel/motor/special equipment feeders, all major underground or underslab conduits, all conduit stubs for future use, any change in branch circuitry from Drawings, key junction boxes and pull boxes not indicated on Drawings, any control locations or indicator lights not shown on Drawings.
 - b. Addendum items, change order items and all changes made to Drawings from Bidding phase through to Project completion.
 - c. Actual equipment and materials installed. Where manufacturer and catalog number are indicated on Drawings, generally or in fixture or equipment schedules, change to reflect actual products installed.
 - d. Change service panel and branch panel breaker locations and schedules to reflect actual installed conditions.
- J. Project Close-out Maintenance Manuals:
 - 1. Prepare 3 copies, unless more are called for under Division 1 (one for Engineer, two for Owner). In addition to requirements under Division 1, provide heavy duty, durable 3-ring vinyl covered loose-leaf binder for each manual sized to receive 8.5 inch by 11 inch paper. Provide a clear plastic sleeve on the spine to hold labels and pockets in the cover to receive folded sheets. In manual, include all Shop Drawings, installation/operation/maintenance data furnished with electrical equipment, voice/data test reports, and letters from manufacturer's representatives that the fire alarm, has been completed and tested to satisfy requirements/codes. List project name, date, and Contractor's name, address and telephone number. Include index sheet for each Specification Section indicating equipment, with supplier and supplier's telephone number. Provide tabbed dividers indicating major groupings of equipment.
 - 2. Turn over to Owner all spare equipment and devices specified and shown.
- K. Supporting Equipment:
 - 1. Unless otherwise indicated, fasten electrical items and their supporting hardware securely to the building structure, including conduits, raceways, cables, cable trays, busways, cabinets, panelboards, transformers, boxes, disconnect switches, and control components. Fasten by means of wood screws or screw-type nails on wood, toggle bolts on hollow masonry units, concrete inserts or expansion bolts on concrete or solid masonry, and machine screws, welded threaded studs, or spring-tension clamps on steel. Threaded studs driven by a power charge and provided with lock washers and nuts may be used instead of expansion bolts and machine or wood screws. Do not weld conduit, pipe straps, or items other than threaded studs to steel structures. In partitions of light steel construction, use sheet metal screws. All device boxes in sheetrock walls will be tight before, during and after installation of sheetrock.
 - 2. Provide supports for electrical items in accordance with NFPA 70 and all other applicable codes.
 - 3. Contractor responsible for providing watertight conduit penetrations at all watertight walls, floors roofs and membranes. Contractor also responsible to maintain fire rating of walls, floors, roofs and membranes penetrated.
 - 4. When applicable, center within insulation any electrical conduit routed in attic space. Provide sealing as per NFPA 70 300-7 for all conduits exposed to different temperatures.

260000 - COMMON WORK RESULTS (continued)

- L. Electrical Identification:
 - 1. Apply circuit/control/item designation labels of engraved plastic laminate for disconnect switches, breakers, pushbuttons, pilot lights, FA duct detection, motor starters, panelboards and main control panel and similar systems.
 - 2. Identify all 120 VAC and 208 VAC power receptacle cover plates with panel and circuit number utilizing a clear label with black designations. Designation example: L1-38.
 - 3. Identify underground exterior electrical circuits by installation of continuous underground plastic marker, 6 - 8 inches below grade.
- 260300 - REMODEL WORK
- A. The Contractor shall carefully examine the Drawings and Specifications, visit the project site, and make note of all existing conditions, dimensions and limitations prior to Bid and make allowances thereto.
 - B. No Change Orders will be issued for Contractor's failure to visit site, remodel work necessary for a complete installation of systems shown, and due to Contractor's lack of understanding of amount or difficulty of work involved.
 - C. The Contractor shall also notify all corporations, companies, individuals or local authorities owning, or having jurisdiction over existing utilities and services which interfere in any manner with the execution of the work under this Contract, and shall remove, relocate or protect such utilities or equipment as required by the parties having jurisdiction over same.
 - D. If existing active or non-active services (which may not be shown on plans) are encountered that require relocation or disconnecting, the Electrical Contractor shall make written request for decision on proper handling of the services. The Electrical Contractor shall not proceed with the work until so authorized by the Architect.
 - E. When areas of the existing buildings are adjacent to the area of construction in which work is going on and are occupied, then this Contractor shall arrange the work so as to reduce to a minimum the periods of interruption or outages in the various services.
 - F. Not less than one week before any system is to be put out of service, the Contractor shall notify and coordinate with other trades and the Owner of such necessity including the extent of the work to be done during the outage, possible length of time required for that phase of the work, and the desired time at which the outage is to begin.
 - G. Balance additional loads to existing circuitry between phases. Furnish a revised, typed panel directory on existing panelboards where loads have been added or changed on this project.
 - H. Carefully lay out all work in advance to minimize cutting, channeling or drilling. Where necessary, all cutting and patching shall be done in a manner approved by the Architect. Do not endanger the stability of the structure. Restore any damaged surfaces to original conditions. Contractor at fault to assume all costs.
 - I. Remove or relocate existing conduits, wires, equipment, devices or fixtures indicated on Drawings and as required by remodel operations. Where the reuse of existing conduits, wires, devices, or fixture is permitted, verify that wiring is continuous. Existing outlets or junction boxes shall not be rendered inaccessible by structural changes made to the building.
 - J. Where existing walls are being furred out or refinished, extend existing outlets and devices to new surface as required.
 - K. Existing equipment which is indicated as being removed and not indicated for re-use shall be disposed of unless stated otherwise. Light fixture ballasts may contain PCB's and shall be disposed of according to environmental regulations.

260519 - CONDUCTORS AND CABLES

- A. Submit Shop Drawings in accordance with the "Common Work Results" Section.
- B. Feeders: Copper THHN-THWN. Solid for No. 10 AWG and smaller; stranded for No. 8 AWG and larger.
- C. Branch Circuits: Copper THHN-THWN. Solid for No. 10 AWG and smaller; stranded for No. 8 AWG and larger.
- D. Multi-conductor Cable: Copper Type AC and Type MC with separate insulated ground wire.
- E. Aluminum conductors are not acceptable.
- F. Conductor Insulation: Comply with NEMA WC 70 for types THHN-THWN. Utilize other types of insulation only where specifically noted or required by code for the installed condition.
- G. Tighten electrical connectors and terminals, including screws and bolts, in accordance with manufacturer's published torque tightening valves or as specified in UL Codes.
- H. Color code secondary service, feeder, and branch circuit conductors with factory applied color as follows:

208y/120 Volts	Phase	480y/277 Volts
Black	A	Brown
Red	B	Purple
Blue	C	Yellow
White	Neutral	Gray
Green	Ground	Green

260533 - RACEWAYS AND BOXES

- A. Submit Shop Drawings in accordance with the "Common Work Results" section.
- B. Conduit Raceway:
 - 1. Indoors, use the following, unless otherwise stated:
 - a. Concealed: EMT or MC cable.
 - b. Exposed: EMT, IMC or RMC.
 - c. Connection to vibrating equipment: Flexible metal conduit.
 - 2. Outdoors, use the following, unless otherwise stated:
 - a. Concealed: RMC or IMC.
 - b. Exposed: RMC or IMC.
 - c. Underground: Schedule 40 PVC with Schedule 80 PVC fittings.
 - d. Connection to Vibrating Equipment: Liquid tight flexible metal conduit.
 - 3. **ENT IS NOT ALLOWED.**
 - 4. Conceal conduit and cable, unless otherwise noted: conduit is permitted to be exposed in equipment rooms. All conduits shall have insulated ground wire installed. Do not install conduit embedded in slabs. EMT fittings shall be steel, compression or set screw type. All raceways shall be installed and supported in accordance with NFPA 70 and applicable codes.
- C. Outlet Boxes:
 - 1. Conform to UL 514A, "Metallic Boxes, Electrical," and UL 514B, "Fittings for Conduit and Outlet Boxes." Outlet boxes shall be metallic and installed flush in all areas, except mechanical rooms, above lay-in ceilings, or as otherwise indicated. Minimum size to be 4 inches square by 2-1/8 inches deep. Boxes shall be of type, shape, size and depth to suit each location and application. All fittings shall be steel.
- D. Pull and Junction Boxes:
 - 1. Comply with UL 50, "Electrical Cabinets and Boxes," for boxes over 100 cubic inches volume. Boxes shall have screwed or bolt-on covers, shall be suitable for the intended application and shall be labeled.
- E. All materials shall be UL listed, appropriate for intended application. Entire raceway system shall be in accordance with NFPA 70, ANSI, NEMA, UL, and all other applicable codes.

260923 - LIGHTING CONTROL DEVICES

- A. Submit Shop Drawings in accordance with the "Common Work Results" Section. Shop drawings shall include background floor plans with device layouts and wiring/wire types, and coverages to demonstrate how this system will function to meet the design intent and the energy code.
- B. Manufacturer: As scheduled on the drawings.
- C. Perform the following tests and inspections:
 - 1. Operational Test: After installing time switches and sensors, and after electrical circuitry has been energized, start units to confirm proper unit operation.
 - 2. Test and adjust controls and safeties. Replace damaged and malfunctioning controls and equipment.
- D. Occupancy Adjustments: When requested within 12 months from date of Substantial Completion, provide on-site assistance in adjusting lighting control devices to suit actual occupied conditions. Provide up to two visits to Project during other-than-normal occupancy hours for this purpose.
- E. Provide letter of verification that the system has been completed and successfully tested. Letter to be included in As-Built manuals.

262726 - WIRING DEVICES

- A. Submit Shop Drawings in accordance with the "Common Work Results" Section.
- B. Acceptable Manufacturers: Pass & Seymour, Bryant, GE, Hubbell, Leviton.
- C. Devices:
 - 1. General light switches shall be 20 amp, 120/277 volt AC rated and **Industrial Grade**.
 - 2. Dimmers shall be as scheduled on the construction documents.

LIGHTING PLAN GENERAL NOTES

- A. ALL EXISTING 2X4 FLAT PANELS IN THE SKY BOXES SHALL BE REMOVED AND RETURNED TO OWNER.
- B. ALL EXISTING DOWNLIGHTS ARE EXISTING TO REMAIN.
- C. RETAIN BRANCH CIRCUIT FROM REMOVED FIXTURES FOR REUSE IN NEW CONSTRUCTION.
- D. SWITCHES ARE SHOWN IN ROOM FOR REFERENCE ONLY LOCATE NEW SWITCH NEXT TO EXISTING SWITCH BANK IN EACH SKY BOX.

KEYNOTES

- 1. EXISTING SWITCH BANK. REMOVE SWITCH TO EXISTING FLAT PANELS AND UPDATE COVER PLATE. MATCH EXISTING STAINLESS STEEL COVER PLATE FINISH.
- 2. CONNECT ALL NEW FIXTURES SHOWN IN ROOM TO EXISTING BRANCH CIRCUIT RETAINED FROM DEMOLITION. CIRCUIT SHALL NOT EXCEED 16A.

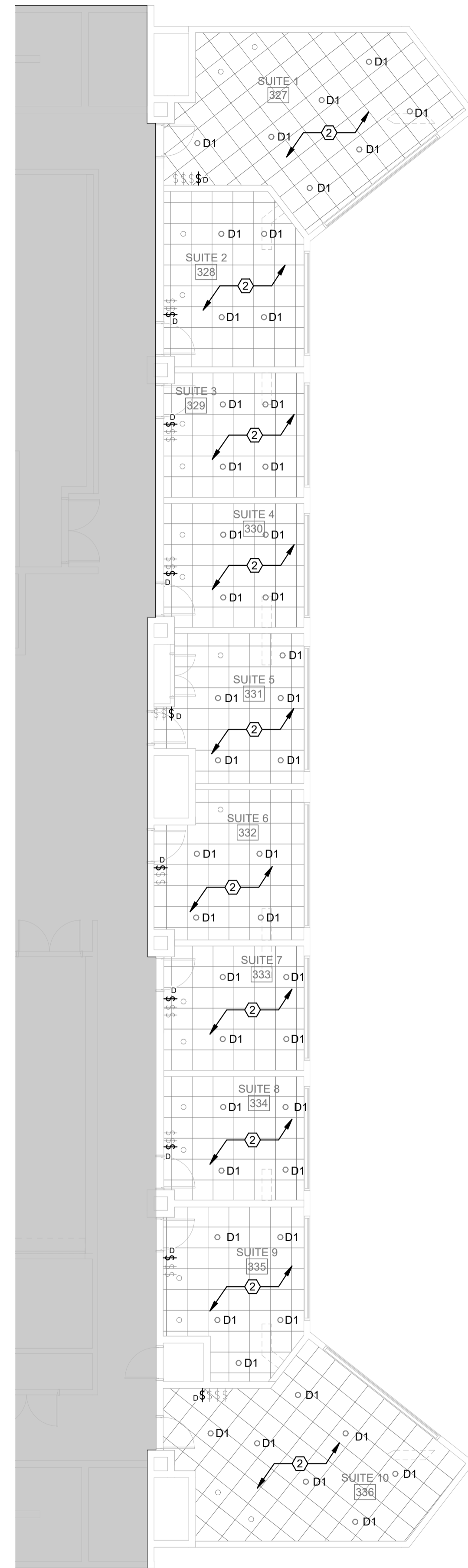
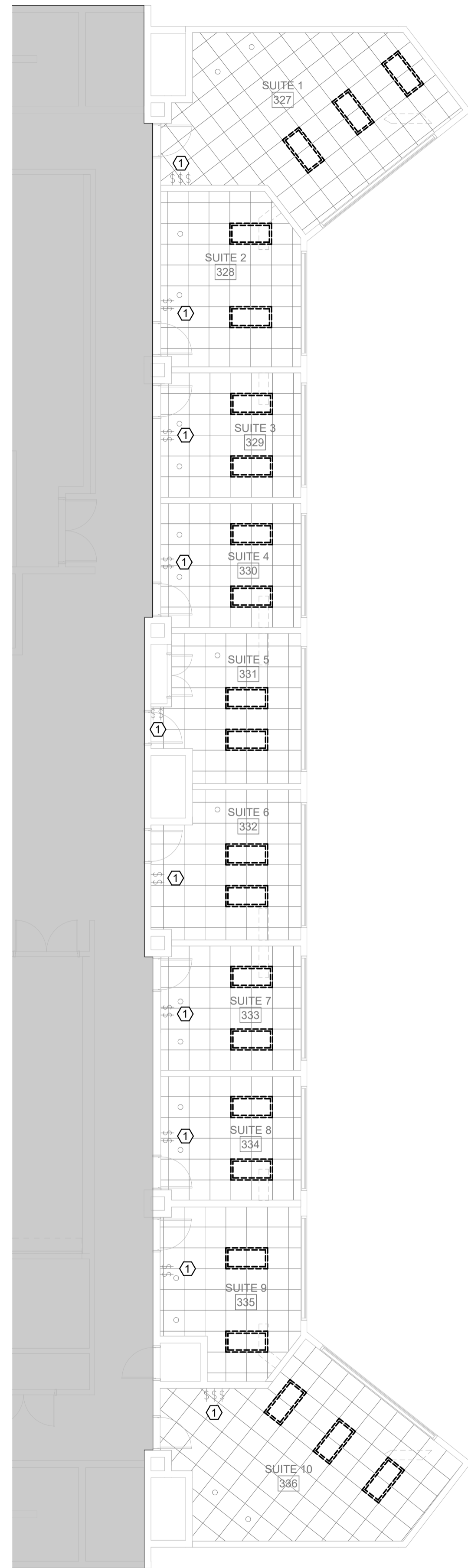

1
E202 2ND FLOOR LIGHTING DEMOLITION PLAN
1/8" = 1'-0"

2
E202 2ND FLOOR LIGHTING REMODEL PLAN
1/8" = 1'-0"

308 6TH AVE N. BILLINGS MT. 59101
YELLOWSTONE COUNTY
METRAPARK SKYBOX REFRESH

© 2025 | ALL RIGHTS RESERVED

CONSTRUCTION DOCUMENTS

10.22.2025
PROJ# | YC25_METBOX
DESIGNED BY | RESTAD
DRAWN BY | RESTAD
REVIEWED BY | HAIDLE
REVISIONS

LIGHTING PLANS

E202