







This document is intended for informational purposes only and is not guaranteed to be accurate nor current.

BLM

**Legend**

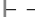
- Easement Type
-  Water feature easements
  -  Dry hydrant easements
  -  Closed/vacated or abandoned
  -  Pedestrian (bike, walking, park, sidewalk)
  -  Road easements (public)
  -  Road easements (private)
  -  Multi-Use easements
  -  All other easements

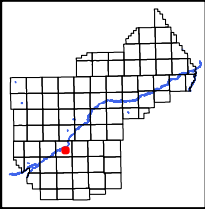

6	5	4	3	2	1
7	8	9	10	11	12
18	17	16	15	14	13
19	20	21	22	23	24
30	29	28	27	26	25
31	32	33	34	35	36

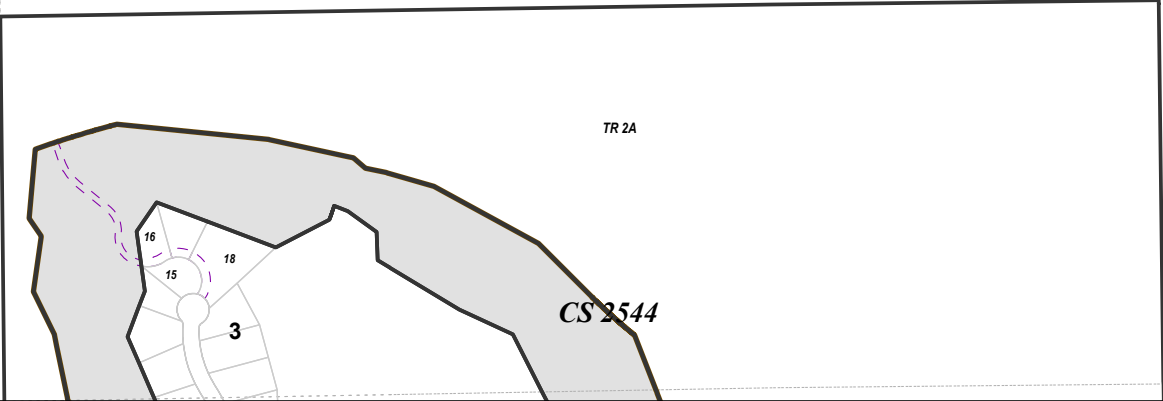

**YELLOWSTONE COUNTY GIS**  
BILLINGS, MONTANA

1 inch = 655 feet  
1 inch = 200 meters  
**SEC 22, T1SR26E**  
Date: 4/7/2026