

**PROJECT CONDITIONS**

- STRUCTURES TO BE DEMOLISHED WILL BE DISCONTINUED IN USE AND VACATED PRIOR TO THE START OF WORK.
- THE OWNER ASSUMES NO RESPONSIBILITY FOR CONDITION OF STRUCTURES TO BE DEMOLISHED.
- CONDITIONS EXISTING AT TIME OF INSPECTION FOR BIDDING PURPOSES WILL BE MAINTAINED BY OWNER AS PRACTICABLE. VARIATIONS WITHIN STRUCTURES MAY OCCUR BY OWNER'S REMOVAL AND SALVAGE OPERATIONS PRIOR TO START OF DEMOLITION WORK.
- UNLESS OTHERWISE INDICATED IN CONTRACT DOCUMENTS OR SPECIFIED BY THE OWNER, ITEMS OF SALVAGEABLE VALUE TO CONTRACTOR SHALL BE REMOVED FROM SITE AND STRUCTURES. STORAGE OR SALE OF REMOVED ITEMS ON SITE WILL NOT BE PERMITTED AND SHALL NOT INTERFERE WITH OTHER WORK SPECIFIED IN CONTRACT DOCUMENTS.

**SITE PREPARATION**

- PROVIDE, ERECT, AND MAINTAIN EROSION CONTROL DEVICES, TEMPORARY BARRIERS, AND SECURITY DEVICES PRIOR TO THE START OF DEMOLITION.
- PROTECT EXISTING LANDSCAPING MATERIALS, APPURTENANCES, AND STRUCTURES WHICH ARE NOT TO BE DEMOLISHED. REPAIR DAMAGE CAUSED BY DEMOLITION OPERATIONS AT NO COST TO OWNER.
- THE CONTRACTOR IS RESPONSIBLE TO PREVENT MOVEMENT OR SETTLEMENT OF ADJACENT STRUCTURES. PROVIDE BRACING AND SHORING AS NEEDED.
- MARK LOCATION OF UTILITIES. PROTECT AND MAINTAIN IN SAFE AND OPERABLE CONDITION UTILITIES THAT ARE TO REMAIN. PREVENT INTERRUPTION OF EXISTING UTILITY SERVICE TO OCCUPIED OR USED FACILITIES, EXCEPT WHEN AUTHORIZED IN WRITING BY AUTHORITIES HAVING JURISDICTION. PROVIDE TEMPORARY SERVICES DURING INTERRUPTIONS TO EXISTING UTILITIES AS ACCEPTABLE TO GOVERNING AUTHORITIES AND OWNER.
- THE CONTRACTOR IS RESPONSIBLE TO CALL 1-800-424-5555 (OR 811) AT LEAST 2 WORKING DAYS PRIOR TO ANY DEMOLITION ACTIVITIES.

**DEMOLITION NOTES**

- THE CONTRACTOR IS RESPONSIBLE FOR PROTECTION OF ALL PROPERTY CORNERS AND PINS.
- THE CONTRACTOR IS RESPONSIBLE FOR REPAIRS OF DAMAGE TO ANY EXISTING IMPROVEMENTS DURING CONSTRUCTION, SUCH AS, BUT NOT LIMITED TO, DRAINAGE, UTILITIES, PAVEMENT, STRIPING, CURB, ETC. REPAIRS SHALL BE EQUAL TO OR BETTER THAN EXISTING CONDITIONS.
- ALL WORK ON THIS PLAN SHALL BE DONE IN STRICT ACCORDANCE WITH THE CITY OF BILLINGS STANDARD MODIFICATIONS TO MONTANA PUBLIC WORKS STANDARD SPECIFICATIONS.
- THE CONTRACTOR SHALL COMPLY TO THE FULLEST EXTENT WITH THE LATEST STANDARDS OF OSHA DIRECTIVES OR ANY OTHER AGENCY HAVING JURISDICTION FOR EXCAVATION AND TRENCHING PROCEDURE. CONTRACTOR SHALL USE SUPPORT SYSTEMS, SLOPING, BENCHING, AND OTHER MEANS OF PROTECTION. THIS IS TO INCLUDE, BUT NOT LIMITED, FOR ACCESS AND EGRESS FROM ALL EXCAVATION AND TRENCHING. CONTRACTOR IS RESPONSIBLE TO COMPLY WITH PERFORMANCE CRITERIA FOR OSHA.
- THE CONTRACTOR SHALL BE RESPONSIBLE FOR PROTECTING THE PUBLIC DURING DEMOLITION, WHICH INCLUDES BUT IS NOT LIMITED TO CONSTRUCTION FENCING, BARRICADES, SIGNAGE ETC.
- THE CONTRACTOR SHALL COORDINATE WITH THE PROJECT OWNER AS TO SPECIFIC DETAILS REGARDING REMOVAL OF EXISTING BUILDINGS, CONTENTS AND ASSOCIATED APPURTENANCES.
- THE CONTRACTOR IS RESPONSIBLE TO INSPECT THE SITE PRIOR TO BIDDING AND INCLUDE IN THE BID ANY AND ALL ITEMS TO BE REMOVED, DEMOLISHED, OR MAINTAINED AS NECESSARY FOR THE CONSTRUCTION OF THIS PROJECT WHETHER THEY ARE SHOWN ON THIS PLAN OR NOT.
- ALL MATERIAL GENERATED FROM DEMOLITION ACTIVITIES SHALL BE DISPOSED OF ONSITE AT AN APPROVED DUMP SITE. SITE SHALL BE COORDINATE BY THE CONTRACTOR WITH OWNER PRIOR TO THE START OF CONSTRUCTION. OWNER TO PROVIDE ONSITE DUMPSTER FOR CONTRACTOR USE.
- THE CONTRACTOR SHALL VERIFY LOCATIONS AND MATERIAL TYPES OF ALL UTILITIES PRIOR TO THE START OF DEMOLITION.
- PROVIDE POSITIVE DRAINAGE AT ALL TIMES WITHIN THE CONSTRUCTION AREA. DO NOT ALLOW WATER TO POND IN EXCAVATION AREAS, AND MAINTAIN ALL EXISTING DRAINAGE PATTERNS.
- TRAFFIC, BOTH VEHICULAR AND PEDESTRIAN SHALL BE PROTECTED BY EFFECTIVE BARRICADES AND SIGNS IN ACCORDANCE WITH MUTCD GUIDANCE AND AS REQUIRED BY THE JURISDICTION HAVING AUTHORITY. EFFECTIVE LIGHTING OF OBSTRUCTIONS SHALL BE PROVIDED AT NIGHT.
- PROTECTION OF PROPERTY - THE CONTRACTOR SHALL BE RESPONSIBLE FOR THE PROTECTION OF PUBLIC AND PRIVATE PROPERTY ADJACENT TO HIS WORK, AND SHALL EXERCISE DUE CAUTION TO AVOID DAMAGE TO SUCH PROPERTY. THE CONTRACTOR SHALL REPLACE OR REPAIR TO THEIR ORIGINAL CONDITION, ALL IMPROVEMENTS WITHIN OR ADJACENT TO THE WORK AREA WHICH ARE NOT DESIGNATED FOR REMOVAL, AND WHICH ARE DAMAGED OR REMOVED AS A RESULT OF OPERATIONS.

**SHEET NOTES**

- CONTRACTOR TO NOTIFY ENGINEER UPON ANY DISCREPANCIES.

**KEY NOTES**

- APPROXIMATE DEMOLITION LIMITS.
- CURB AND GUTTER TO BE REPLACED TO NEAREST JOINT IN AREAS OF NOTABLE DAMAGE OR SETTLEMENT.
- EXISTING ASPHALT TO BE REMOVED.
- EXISTING CONCRETE TO BE SAWCUT AND REMOVED TO NEAREST JOINT.
- EXISTING WHEEL STOPS TO BE REMOVED.
- EXISTING LANDSCAPING PLANTER BED TO BE PROTECTED IN PLACE.
- EXISTING STORM INLETS TO REMAIN. PROTECT IN PLACE.
- EXISTING UNDERGROUND UTILITIES TO REMAIN.
- EXISTING LIGHT POLES TO PROTECT IN PLACE.
- EXISTING SIGNS TO BE REMOVED.
- EXISTING SIGN FOUNDATION TO BE REMOVED.
- EXISTING TREE TO BE REMOVED.
- EXISTING LANDSCAPE PLANTER BED TO BE REMOVED.
- CAUTION: EXISTING UNDERGROUND CONCRETE ACCESS TUNNEL. CONTRACTOR TO USE CAUTION IN DEMOLITION AND CONSTRUCTION. CONTACT ENGINEER DURING DEMOLITION WITH ANY CONFLICTS.
- DEMOLISH BUSINESS SIGN. VERIFY WITH OWNER IF THEY WANT TO SALVAGE ANY OF SIGNAGE.

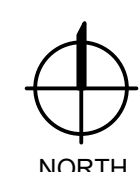
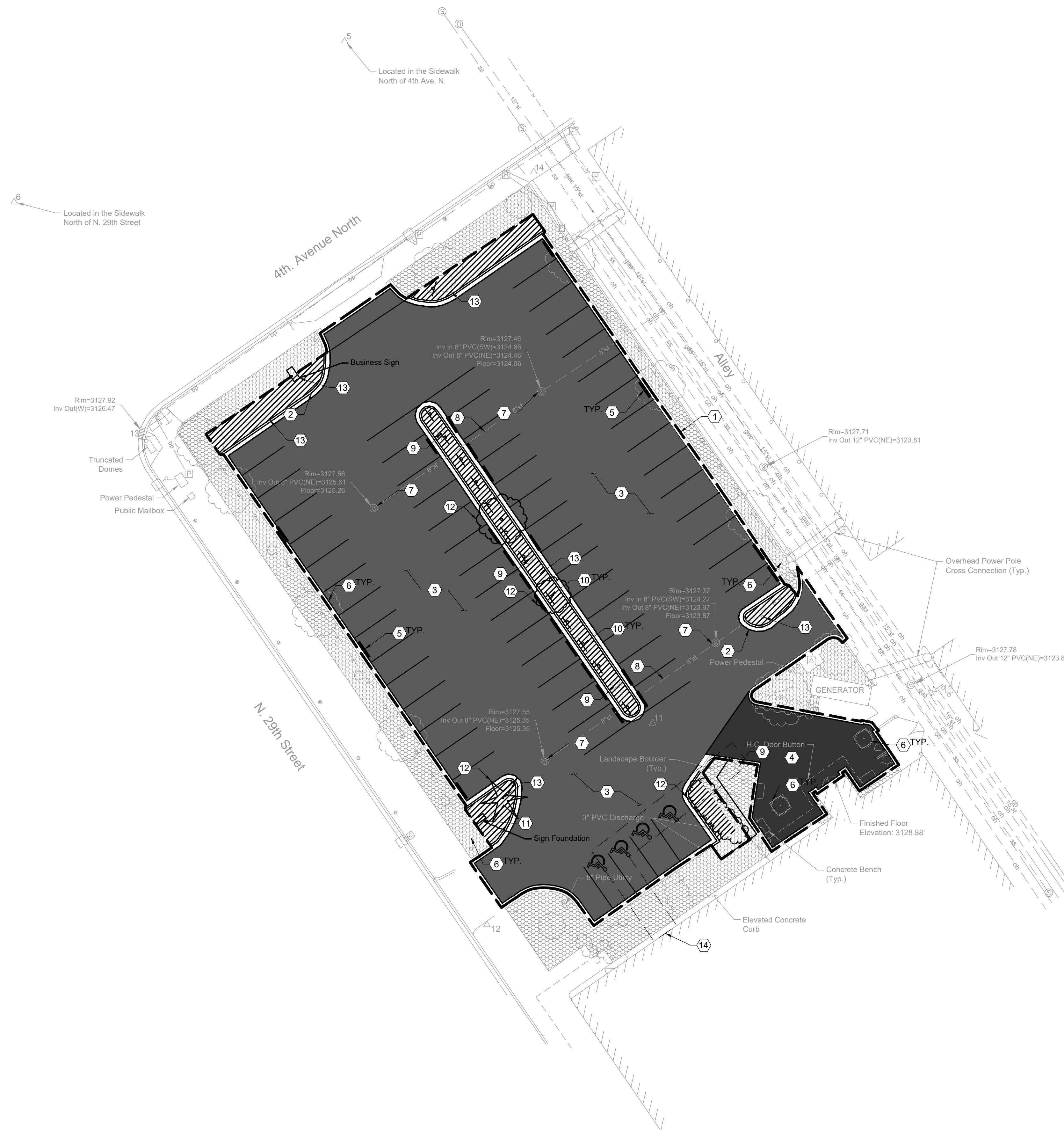

1 DEMOLITION PLAN  
C002

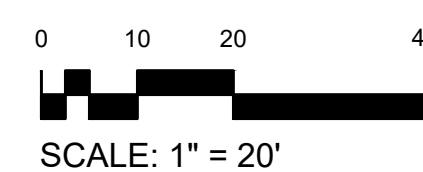

YELLOWSTONE COUNTY  
2825 3RD AVE. NORTH, BILLINGS, MT  
**ADMINISTRATION BUILDING RENOVATION**

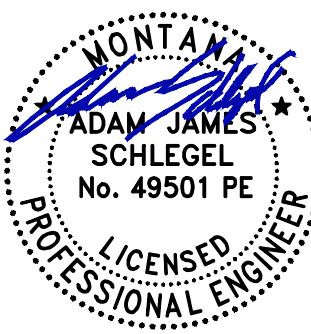

© 2025 | ALL RIGHTS RESERVED

CONSTRUCTION DOCUMENTS

09.04.2025  
PROJ# | YC23\_ADMRENO  
DESIGNED BY | MIRANDA  
DRAWN BY | JOHNSON  
REVIEWED BY | SCHLEGEL  
REVISIONS  
PR 15 04.28.2026

DEMOLITION PLAN

C002

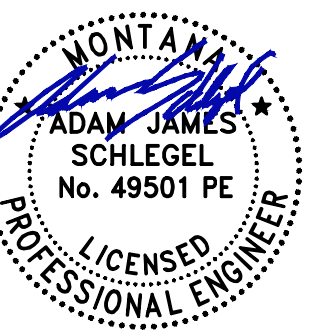

**CONSTRUCTION NOTES**

1. THE CONTRACTOR SHALL REFER TO BUILDING PLANS FOR LOCATION AND DIMENSIONS OF SLOPED PAVING, EXIT PORCHES, TRUCK DOCKS, BUILDING DIMENSIONS, BUILDING ENTRANCE LOCATIONS, TOTAL NUMBER, LOCATIONS AND SIZES OF ROOF DOWNSPOUTS.
2. ALL TRAFFIC CONTROL SIGNS SHALL BE FABRICATED AS SHOWN IN THE NATIONAL MANUAL ON UNIFORM CONTROL DEVICES FOR STREETS AND HIGHWAYS EXCEPT AS NOTED ON THE PLANS.
3. ALL CURB RADII SHOWN ARE TO FACE OF CURB.
4. ALL PAVING DIMENSIONS ARE TO FACE OF CURB, WHERE APPLICABLE, UNLESS OTHERWISE NOTED.
5. ALL COORDINATES SHOWN ARE TO FACE OF CURB OR OUTSIDE OF WALL.
6. THE CONTRACTOR SHALL MATCH EXISTING PAVEMENT IN GRADE AND ALIGNMENT.
7. THE CONTRACTOR SHALL MATCH EXISTING CURB AND GUTTER IN GRADE, SIZE, TYPE AND ALIGNMENT AT ADJACENT ROADWAYS, UNLESS OTHERWISE NOTED.
8. THE CONTRACTOR IS RESPONSIBLE FOR REPAIRS OF DAMAGE TO ANY EXISTING IMPROVEMENTS DURING CONSTRUCTION, SUCH AS, BUT NOT LIMITED TO, DRAINAGE, UTILITIES, PAVEMENT, STRIPING, CURB, ETC. REPAIRS SHALL BE EQUAL TO OR BETTER THAN EXISTING CONDITIONS.
9. ALL WORK ON THIS PLAN SHALL BE DONE IN STRICT ACCORDANCE WITH THE PROJECT SPECIFICATIONS.

**PAVING NOTES**

1. PAVEMENT SHALL BE PLACED IN ACCORDANCE WITH THE CITY OF BILLINGS STANDARD MODIFICATIONS TO MONTANA PUBLIC WORKS STANDARD SPECIFICATIONS.
2. PAVEMENT SECTION RECOMMENDATIONS WERE TAKEN FROM THE GEOTECHNICAL REPORT.

**(#) KEYNOTES**

1. RESTORE ASPHALT PAVEMENT, SEE 1/C400.
2. CONCRETE PAVEMENT, SEE 2/C400.
3. 'SPILL' CURB & GUTTER, SEE 4/C400 FOR AREAS DEEMED NECESSARY TO REPLACE.
4. NEW 4" YELLOW PAVEMENT STRIPING.
5. NEW A.D.A. STRIPING PER PLAN.
6. NEW ACCESSIBLE ROUTE STRIPING.
7. NEW TRAFFIC CONTROL STRIPING.
8. INSTALL A.D.A. SIGNAGE W/ 'VAN' PLACARD WHERE NOTED.
9. EXISTING A.D.A. AND EMPLOYEE PARKING SIGNS TO REMAIN, COORDINATE WITH OWNER FOR ANY SIGN RELOCATION.
10. CONCRETE PLANTERS TO ACT AS VEHICLE BARRIERS. OWNER TO SELECT TYPE, COLOR AND MATERIAL.
11. BARRIER ARM GATES. BASIS OF DESIGN FAAC B680H OR APPROVED EQUAL.
12. 6" BOLLARDS. SEE DETAIL 5/C400.
13. NEW "SPILL" CURB AND GUTTER TO BE ADDED. SEE DETAIL 4/C400.
14. CONCRETE PEDESTAL FOR BARRIER ARM CONTROLLER. SIZE AND STANDARDS TO COMPLY WITH MANUFACTURER REQUIREMENTS. COORDINATE WITH ELECTRICAL FOR POWER SUPPLY TO GATE CONTROLLER.
15. DO NOT ENTER SIGN. PER MUTCD.
16. CAUTION: EXISTING UNDERGROUND CONCRETE ACCESS TUNNEL. CONTRACTOR TO USE CAUTION IN DEMOLITION AND CONSTRUCTION. CONTACT ENGINEER DURING CONSTRUCTION WITH ANY CONFLICTS.

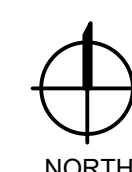
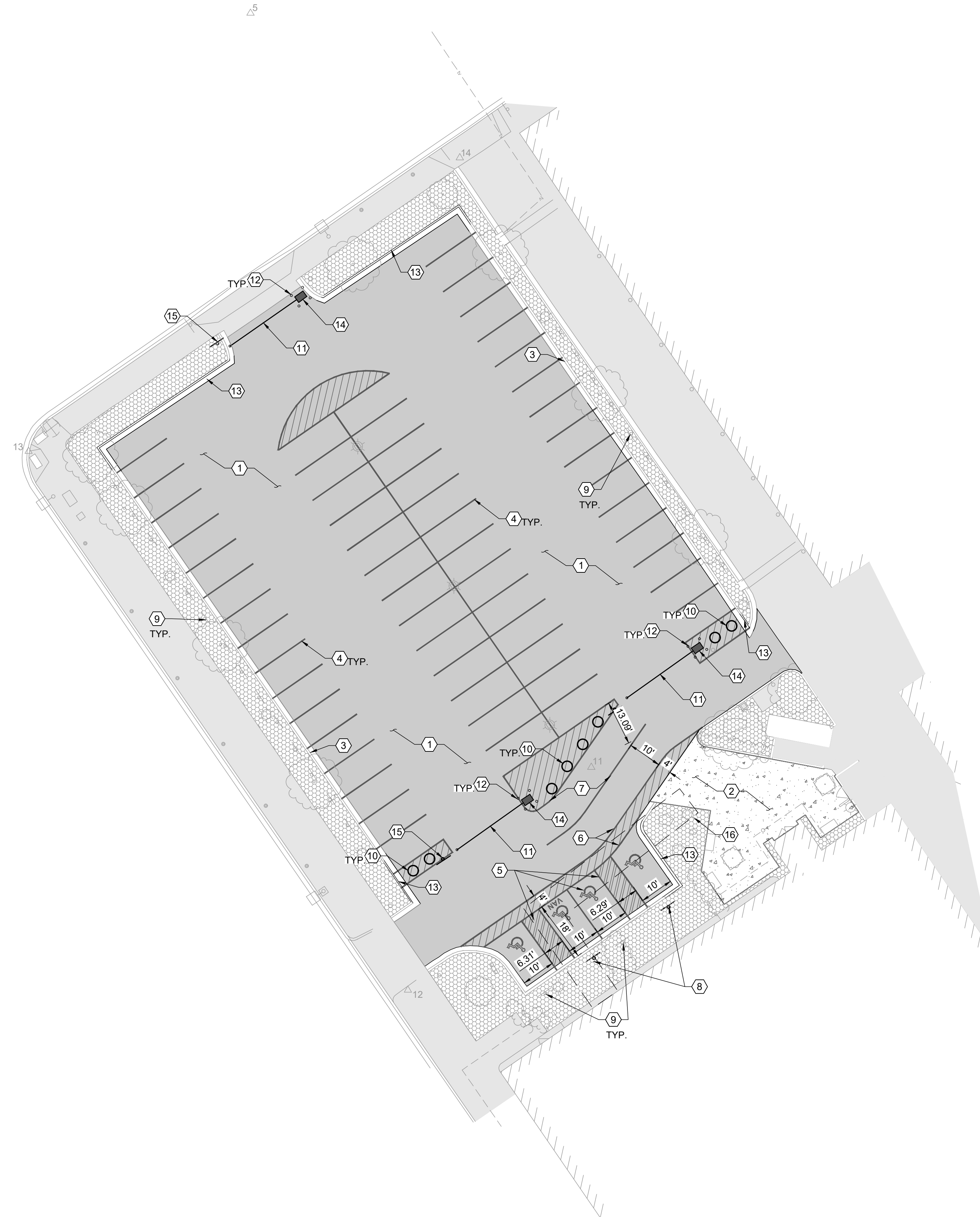

1 SITE PLAN  
C100

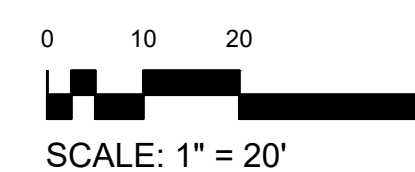

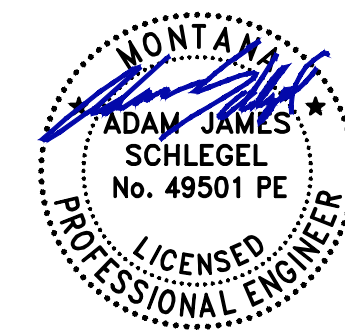

**GRADING NOTES**

1. SITE GRADING SHALL NOT PROCEED UNTIL THE SWPPP HAS BEEN IMPLEMENTED.
2. ALL EARTHWORK AND GRADING SHALL PROCEED IN ACCORDANCE WITH THE GEOTECHNICAL REPORT.
3. NO MATERIAL SHALL BE EXCAVATED, MOVED, OR COMPACTED WITHOUT THE PRESENCE OR AUTHORIZATION OF THE OWNER'S REPRESENTATIVE.
4. THE CONTRACTOR IS RESPONSIBLE TO VERIFY EXISTING CONDITIONS AND LOCATE ALL EXISTING UTILITIES PRIOR TO COMMENCING EARTH. NOTIFY ENGINEER OF ANY UNFORESEEN CONDITIONS.
5. CONTRACTOR TO PROTECT ALL EXISTING UTILITIES, SIGNS AND EXISTING STRUCTURES AND REPAIR BACK TO ORIGINAL CONDITION IF DAMAGE HAS OCCURRED DURING CONSTRUCTION.
6. PROVIDE POSITIVE DRAINAGE AWAY FROM ALL STRUCTURES.
7. GRADES SHOWN REPRESENT FINISH GRADES UNLESS OTHERWISE NOTED.
8. SPOT ELEVATIONS INDICATE TOP OF ASPHALT, UNLESS OTHERWISE INDICATED.
9. FINISHED GRADE SPOT ELEVATIONS HAVE BEEN TRUNCATED. ADD 3100 FOR ACTUAL ELEVATION.
10. LONGITUDINAL SLOPES OF ALL SIDEWALKS SHALL NOT EXCEED 5%, EXCEPT FOR ON INDICATED RAMPS.
11. GROSS SLOPES OF ALL SIDEWALKS SHALL NOT EXCEED 2%. 1.5% IS PREFERRED.
12. PEDESTRIAN RAMPS SHALL NOT EXCEED 12H:1V IN ANY DIRECTION.
13. ADA PARKING AND ADA UNLOADING/LOADING AREAS SHALL NOT EXCEED 2% IN ANY DIRECTION. CONTRACTOR TO VERIFY GRADES OF BASE MATERIAL AND FORMS BEFORE PAVING INSTALLATION.
14. EXTERIOR CONCRETE FLATWORK ADJACENT TO BUILDINGS SHALL SLOPE AWAY FROM THE BUILDING AND NOT EXCEED 2%. 1% IS THE MINIMUM.
15. PROPOSED GRADE CONTOUR INTERVAL SHOWN AT HALF FOOT (0.5').
16. CONTRACTOR SHALL COMPLY TO THE FULLEST EXTENT WITH THE LATEST STANDARDS OF OSHA DIRECTIVES OR ANY OTHER AGENCY HAVING JURISDICTION FOR EXCAVATION AND TRENCHING.
17. THE EARTHWORK FOR ALL BUILDING FOUNDATIONS AND SLABS SHALL BE IN ACCORDANCE WITH BUILDING PLANS AND SPECIFICATIONS.
18. THE CONTRACTOR IS RESPONSIBLE TO CALL 1-800-424-5555 (OR 811) AT LEAST 2 WORKING DAYS PRIOR TO ANY EARTH DISTURBING ACTIVITIES OR UTILITY EXCAVATIONS.

**GRADING LEGEND**

	PROPOSED 'FLOW LINE' ELEV.
	PROPOSED 'MATCH EXISTING GRADE TOP OF CONCRETE' ELEV.
	PROPOSED 'MATCH EXISTING GRADE RIM' ELEV.
	PROPOSED 'MATCH EXISTING GRADE TOP OF ASPHALT' ELEV.
	PROPOSED SLOPE
	PROPOSED CONTOUR
	EXISTING CONTOUR
	PROPOSED GRADE BREAK HIGH POINT
	EXISTING STORM STRUCTURE

**GRADING NOTES**

1. EXISTING AND PROPOSED CONTOURS ARE FOR REFERENCE ONLY.
2. FINISHED GRADES SHOULD BE ESTABLISHED THROUGH SPOT GRADES.
3. CONTOUR INTERVAL: 0.5'

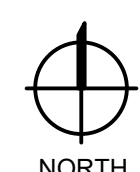
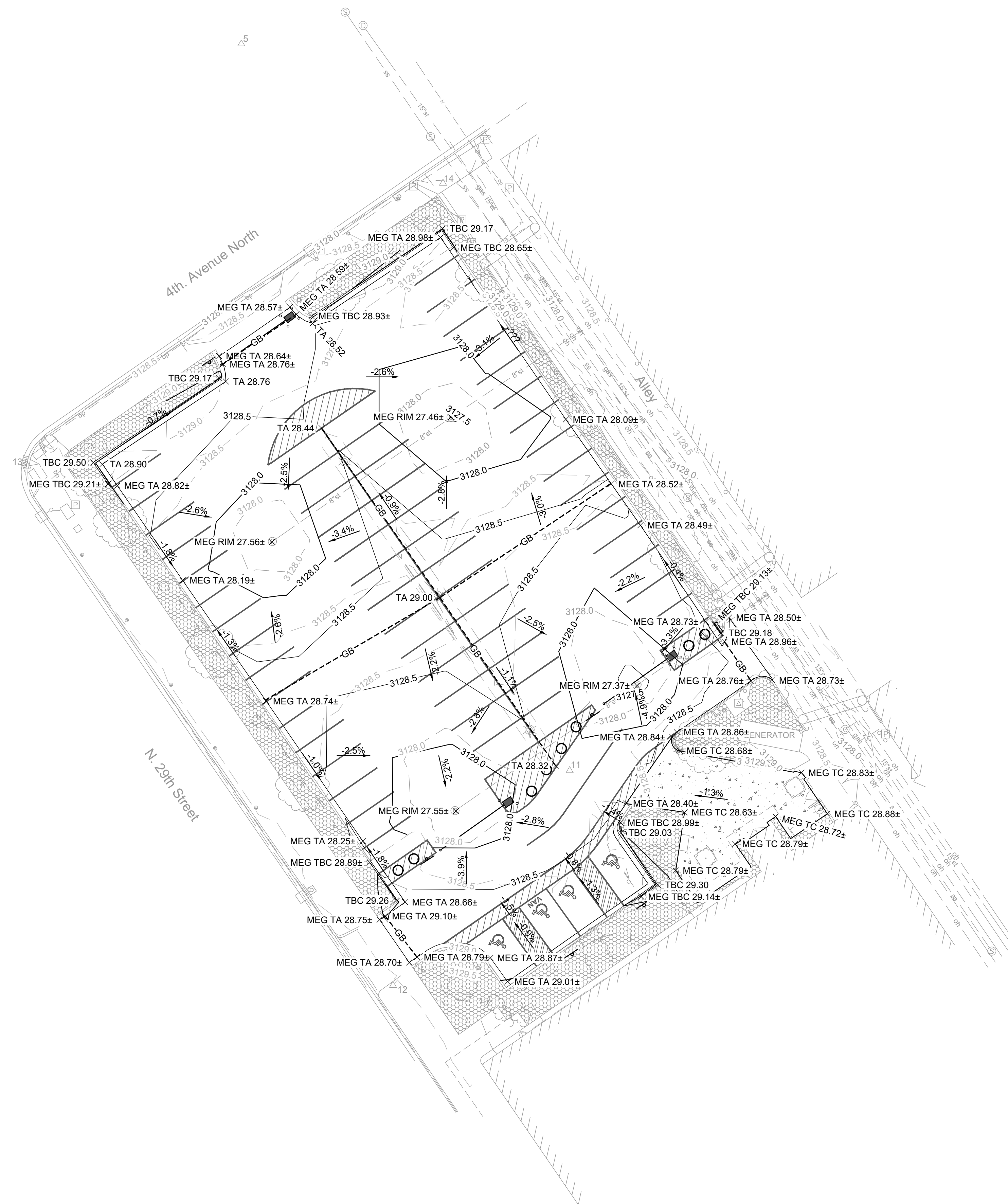

1 GRADING AND DRAINAGE PLAN  
C200

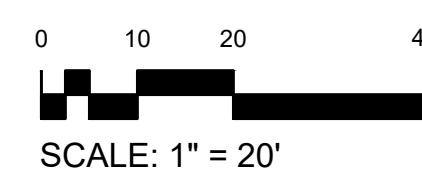

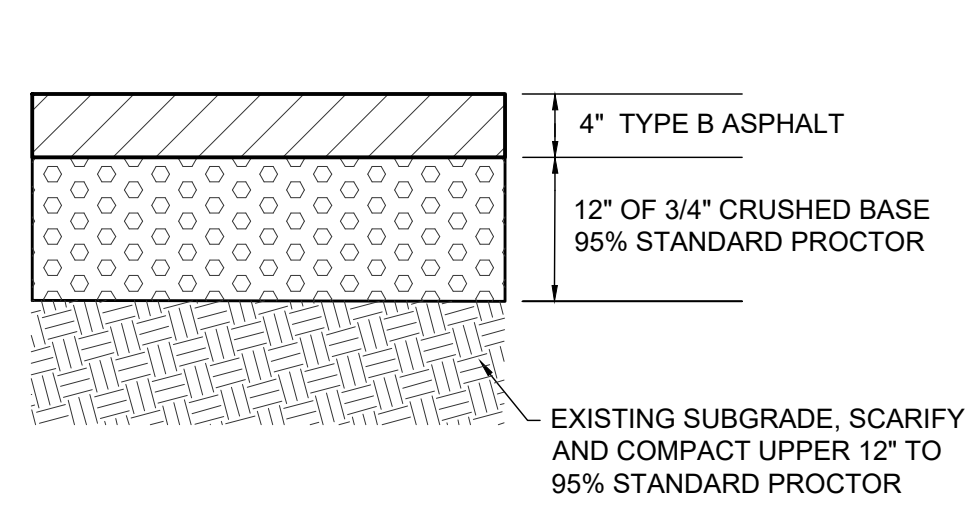

1 TYPICAL ASPHALT SECTION  
C400 NOT TO SCALE

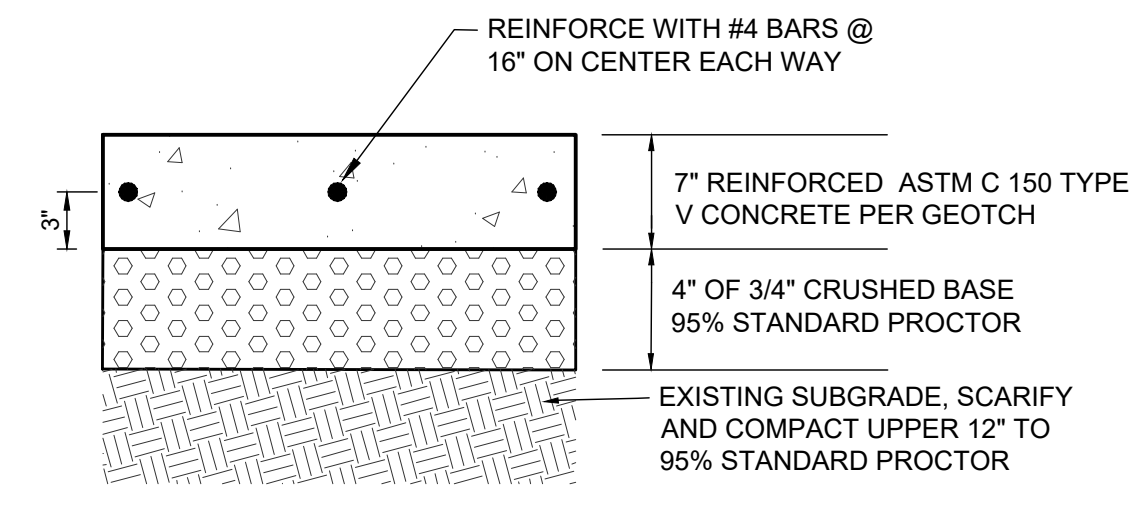

2 HEAVY DUTY CONCRETE  
C400 NOT TO SCALE

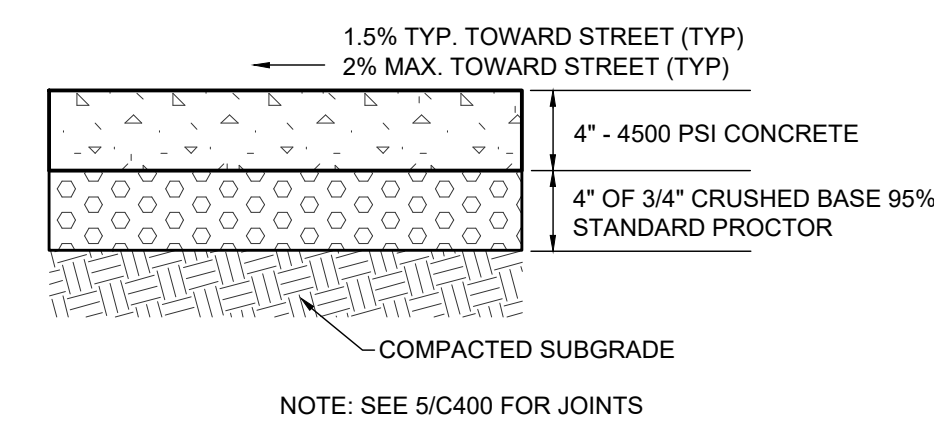

3 TYPICAL SIDEWALK SECTION  
C400 NOT TO SCALE

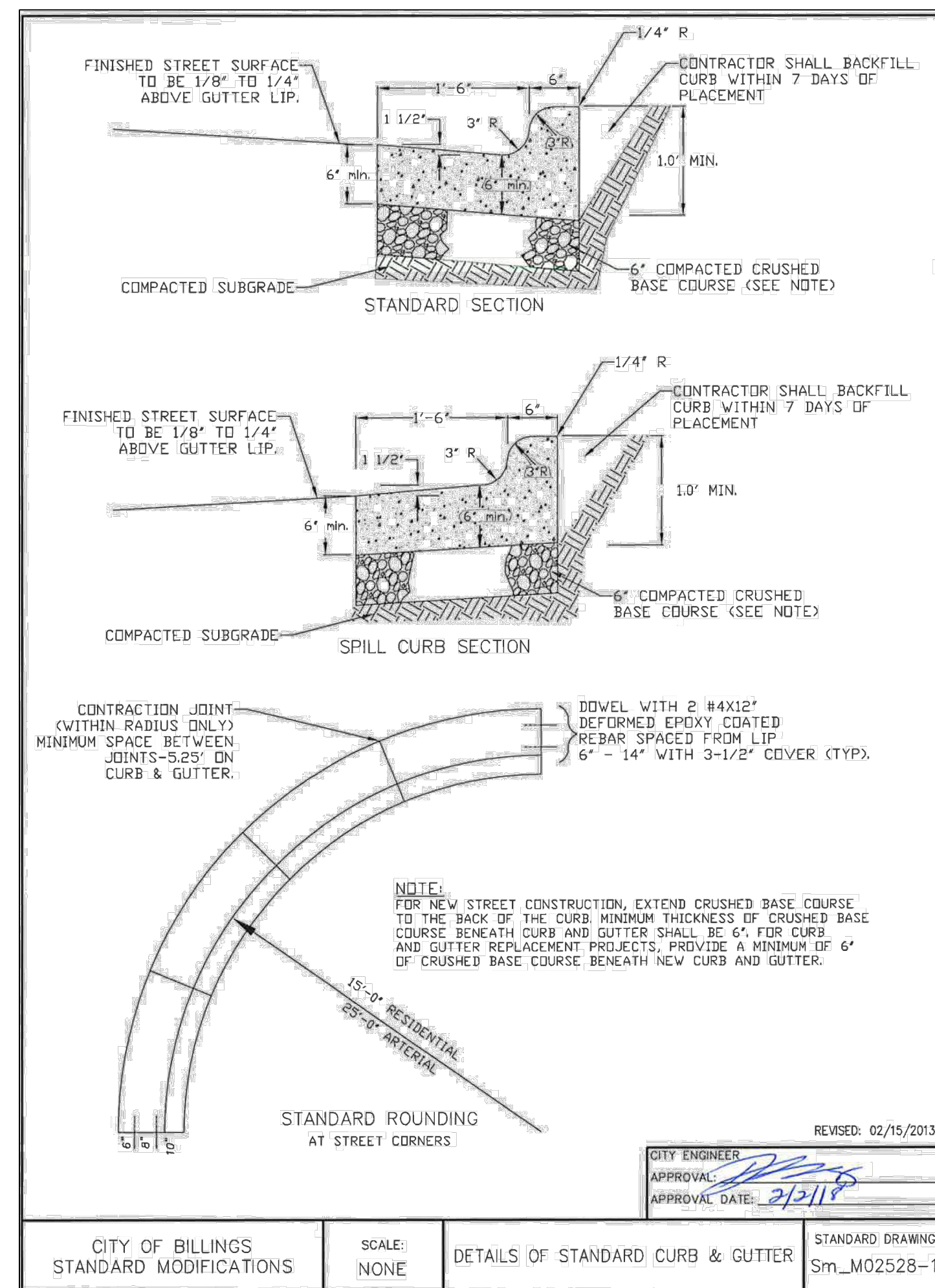

4 STANDARD CURB & GUTTER  
C400 BILLINGS Sm#02528-1 NOT TO SCALE

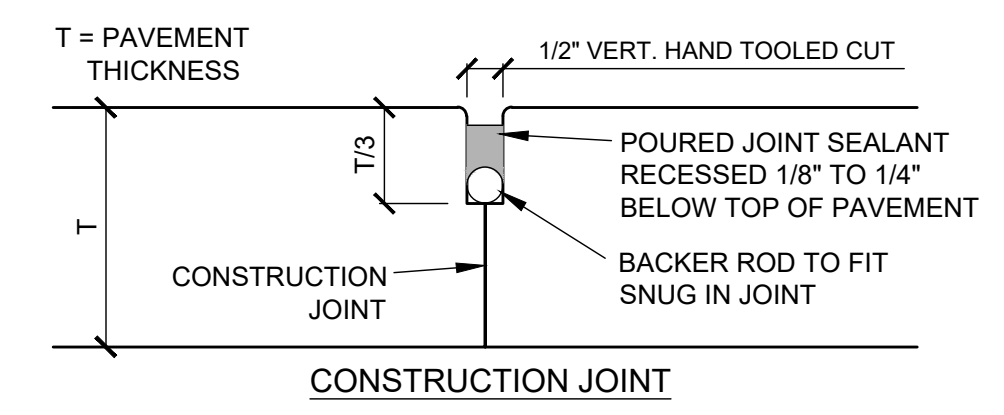
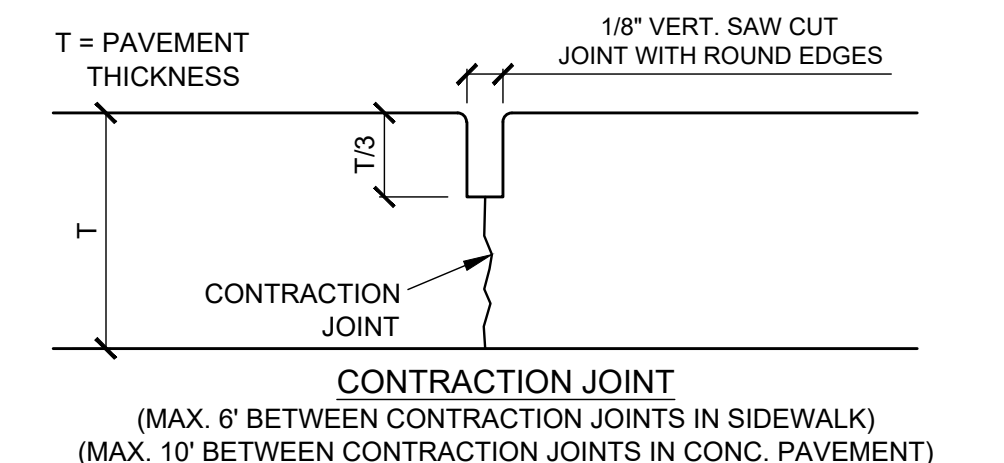
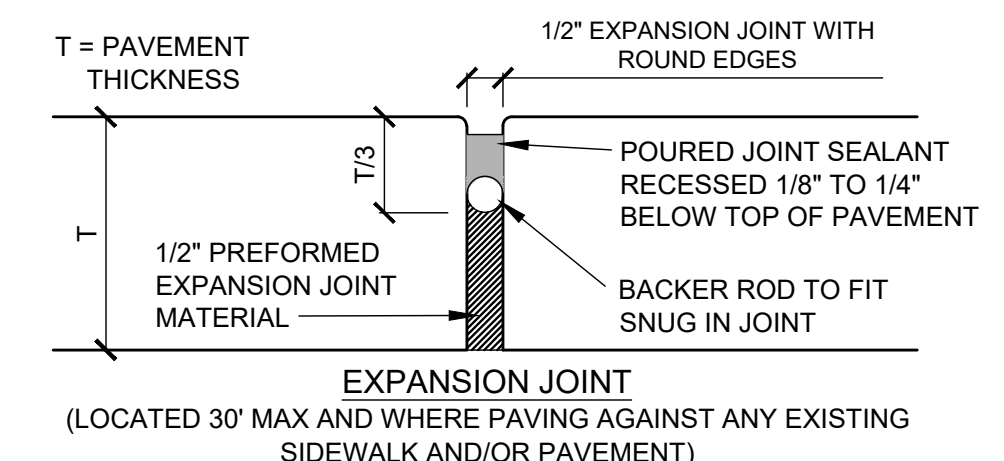

5 CONCRETE JOINT  
C400 NOT TO SCALE

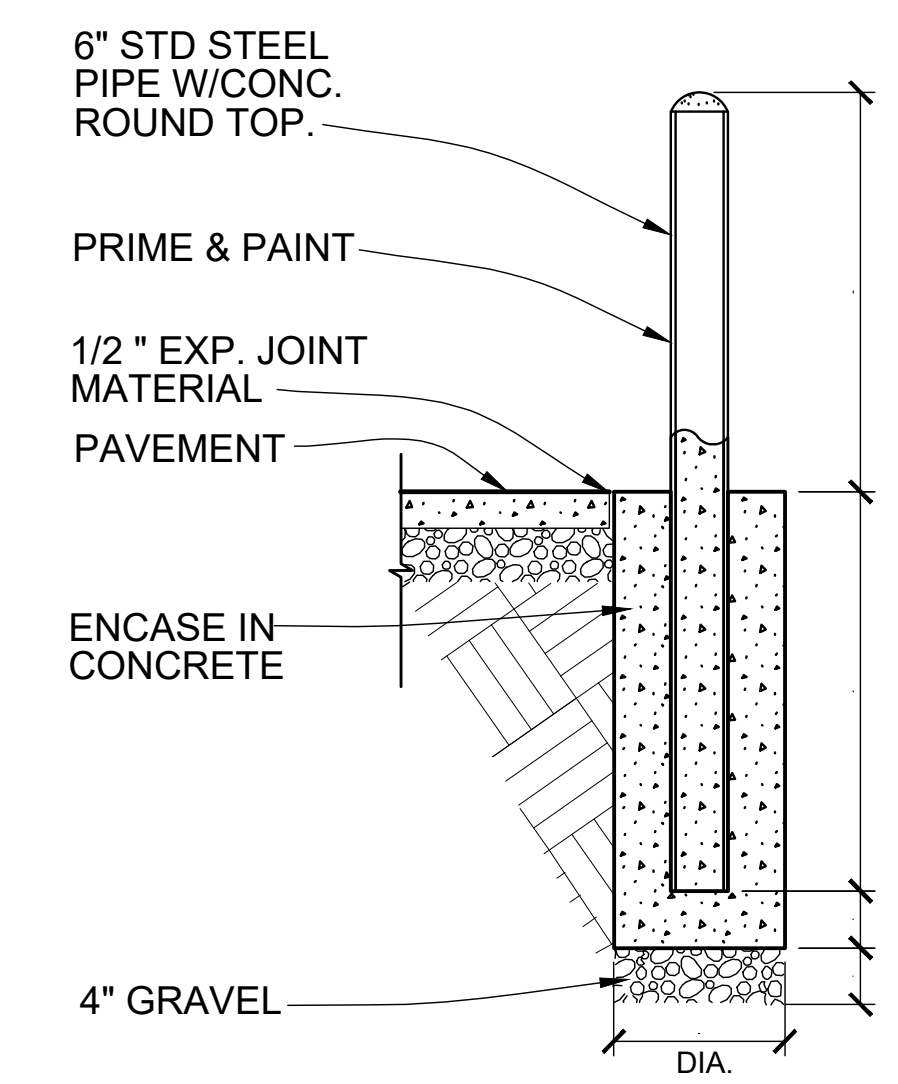

5 PIPE BOLLARD  
C400 NOT TO SCALE

YELLOWSTONE COUNTRY  
2825 3RD AVE. NORTH, BILLINGS, MT  
ADMINISTRATION BUILDING RENOVATION

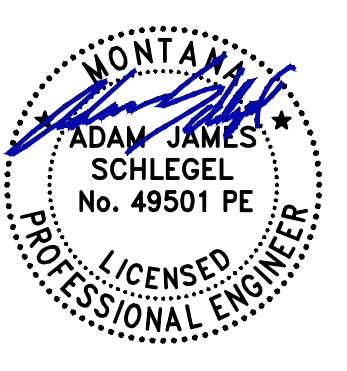

© 2025 | ALL RIGHTS RESERVED

CONSTRUCTION DOCUMENTS

09.04.2025  
PROJ# | YC23\_ADMRENO  
DESIGNED BY | MIRANDA  
DRAWN BY | JOHNSON  
REVIEWED BY | SCHLEGEL  
REVISIONS  
PR 15 04.28.2026

CIVIL DETAILS

C400