

Request for Wall Mounted Touchscreen in Lobby of CAB

The County will be facing significant “juggling” of space and locations over the next two – three years. This will include the major move to the CAB, the new Extension Building and the opening of Cedar Hall.

In this process, we want to stay sensitive to the needs for information sought by our citizens in such a way as to add convenience and centralized locations to find answers.

We are proposing a touchscreen, wall mounted display for the lobby of the CAB. Once this is set up, it will save significant time and energy on the part of our citizens and staff, while providing information not currently available in any convenient form.

The proposal attached is from a firm recommended from a local company we use for many of our IT needs, via our IT Department.

Here’s why this makes sense.

- There is a one-time cost, with minimal ongoing costs to maintain (\$1,499).
- It is a proven touchscreen that invites public access to find locations of all County services – courts, County shop, Detention, Metra, etc., departments by floor in the CAB, upcoming public meetings, community events, Metra events, messages from the BOCC, and the like. It also displays a QR code that a user can scan with their smartphone to get information on the go.
- This will save time for our security desk in the lobby, and employees who get stopped by citizens for directions, etc.
- It is in government offices around the country, and even in one of our local medical buildings.

It is interesting to note that it appears that, independent of our search, the architect for the courthouse remodel is suggesting this same type of user-friendly display for the lobby of the courthouse as that building faces more remodeling.

We prefer the wall mounted display in this case vs. the floor mounted kiosk for reduced cost and better security of the unit. Estimated costs, excluding mounting and connections will be between \$16,000 (43” screen)- \$20,000 (55” screen). We prefer the larger one for two reasons. First, is the easier viewing from a distance and the second is because the 55” screen is a standard model always available, ensuring parts are easy to get many years into the future.



TouchSource LLC
1370 Miners Drive, Suite 103
Lafayette, CO 80026
United States



Prepared for:
Yellowstone County

Created by:
Kimberly Morrow
+1 5402507655
kimberlym@touchsource.com

Date:
05-01-2025

Quote number:
Q-18057

Payment method:
50% Deposit, Net 30

Expiration date:
05-31-2025

Why TouchSource?

TouchSource is your proven partner in effortless place-based communications. Collaborate with us to build a sense of place that forges human connections with compelling digital experiences that evolve with the needs of your community. Our turnkey solutions combine user-friendly feature-rich software, design, unlimited remote support, and hardware for effortless upkeep. Effortlessly oversee multiple buildings and displays through our user-friendly dashboard, designed for intuitive management across various locations. TouchSource exclusively uses high quality products and certified professionals, backed by the industry's best warranty services. Over 11,000 customers proudly served the TouchSource way.

TouchSource Difference

EASY TO PLAN	EASY TO DEPLOY	EASY TO OWN
TRANSFORM VISION TO REALITY Plan a unique place-based experience with our digital solutions advisors whose expertise makes it easy to choose the most effective solution. Select from the highest quality products, best feature set and easiest-to-deploy products in the industry.	TURNKEY SOLUTIONS All-in-one, turnkey solutions combine the design, unlimited remote support, software, and hardware for effortless upkeep. Add in our installation services from certified professionals to take one more project step off your plate.	QUALITY THAT STANDS THE TEST OF TIME TouchSource uses only time-tested products, backed by the industry's best warranty services. We design our systems to be complete, quality tested, and designed to last. Why risk time, credibility and money on unproven vendors?
DESIGN THE EXPERIENCE Full-service professional design so your digital solution delivers a memorable experience that shapes your space. Get the installation advice and services you need for an easy-to-manage project.	PROJECT TEAM Our team of experts advises you every step of the way. You're assigned a customer success manager who gathers your content, reviews design choices, prepares your product and streamlines installation.	POWERFUL EASY TO USE PLATFORM Only TouchSource delivers the Spark PX™ next-generation platform for place-based communications. Instant, intuitive content management across your entire property portfolio.
PREDICTABLE COST OF OWNERSHIP We provide upfront pricing transparency in total cost of ownership. Our reliably high-quality products, unlimited remote support and full-service warranty program deliver unmatched cost reliability.	EASY ONBOARDING Our experts take the work off your plate in designing, loading content, quality-testing your software in your display, and troubleshooting questions.	PORTFOLIO-WIDE MANAGEMENT Manage multi-building and multi-display buildings from an intuitive dashboard. Our software is intuitive, designed for business users, and integration-ready.
TRUSTED PARTNERSHIP Justifying building signage investments can be a challenge. We're the industry's most trusted solution because we make it simple to own, deliver only the best, and back our promises.	RELIABLE EXCELLENCE We have a bench of industry experts, scale of solutions, and supplier relationships to deliver a reliably great set of product, services, and ownership experience regardless of supply chain and industry headwinds.	SPARK COMMUNITY EXPERIENCES Deliver compelling, always up-to-date art and content that you can post instantly across your entire network to spark a place-based communications experience for your community.

Wayfinding			
Product	Description	List Unit Price	Net Total
WAY-ANIM-PATH	Animated Paths draw lines with turn-by-turn directions from directory to destination on your building's floor plans. Pricing varies based on the specifics of your building. This quote pricing is based on: Number of Floor Plans - 6, Total Destinations - 30, Number of Directories - 1, Dimension - 2D, Number of Orientations - 1.	\$3,900.00	\$3,900.00 x 1 \$3,900.00
			Total: \$3,900.00

Please note that the following items are optional and not included in the total cost:

Pantella 43" Vertical Touch Display Wall Mount			
Product	Description	List Unit Price	Net Total
PT-43V-TO 	Pantella surface-mount wall unit: - Face with brushed stainless steel finish and "DIRECTORY" in black 3M Vinyl - Back plate for mounting to wall - 43-inch high resolution flat panel LED commercial grade 24x7 rated touch screen monitor in VERTICAL orientation - Digital media player with TouchSource Software	\$7,900.00	\$7,900.00 x 1 \$7,900.00
EXTENDED-WARRANTY	2 year warranty is included standard, the extended warranty offers an additional 3 years of coverage. It is optional please let your TouchSource rep know if you'd like to opt out of the extension. Protect yourself from the unexpected with an extended warranty from the time of purchase. Covers the costs of unlimited remote support for the equipment and replacement in the case of a covered failure. Full details in the appendix of your quote or on https://touchsource.com/about/warranty . The cost of a new solution or hardware replacement can be 250-500% greater than the price of the warranty. Eliminate surprise costs from your budget today. The warranty is transferable to the new owner until the end of the contract term in the case that the property is sold.	\$987.50	\$987.50 x 1 \$987.50

TS-ENGAGE	<p>Annual Subscription</p> <p>Curated Visual Infotainment Looks Stunning on Popular Large Displays</p> <ul style="list-style-type: none"> - Infotainment – Choose one feed of curated news, entertainment, sports or popular content to entertain and entice visitors to use your directory - Local Amenities & Traffic – Deliver information on local restaurants, traffic and more for fast access to relevant information - Mobile Directory – Stunning, easy-to-use directories and messaging boards that deliver interactivity how you want it—touch, mobile, or both! - Events Listings – Automatically display all of the meetings or events scheduled for your conference rooms or events center from your Outlook 365 or Google Calendar - QR Code Surveys – Deploy surveys, self-service check-in and other forms using QR codes for mobile delivery - Digital Content – Building listings, messaging, and news inform and inspire visitors - Simple Access – Secure, easy-to-use platform and unlimited remote support <p>**Select images or a motion scenery video from our library included. Premium art available as an add-on.</p>	\$1,499.00	<p>\$1,499.00 x 1 \$1,499.00</p>
TS-SUPPORT-ESS	<p>Included With All Directory Software Subscriptions</p> <p>Responsive, US-Based Support</p> <ul style="list-style-type: none"> - Unlimited telephone, email, chat and web access to support North America-based technicians - Online customer portal support & access to immediate support - Self-service support documents & tools <p>Proactive software updates</p> <ul style="list-style-type: none"> - Security patches - Operating System updates - Web backups - Software updates 	\$0.00	<p>\$0.00 x 1 \$0.00</p>
TS-MONITORING	<p>Annual Subscription</p> <p>The Proactive Monitoring solution gives you piece of mind and highest uptime while TouchSource uses our proprietary toolsets, workflow automation, and machine learning capabilities to proactively monitor your systems for issues that could impact your digital sign.</p>	\$499.00	<p>\$499.00 x 1 \$499.00</p>

INSTALL-PT-SIMPLE	<p>Installation Activities:</p> <ul style="list-style-type: none"> - Full installation of wall-mount unit: technician will mount the unit onto the wall, install CPU and monitor, and test directory. The technician will clean the area before leaving. - Installation on drywall or wooden frame (ONLY) with sufficient backing and/or structural support. - Cardboard and general debris are disposed of onsite, but removal and disposal of pallets, crates, and existing installations are not included in the scope. - Work to be performed during normal business hours: 8:00-5:00 pm Monday through Friday. - Labor provided is non-union. - This quote assumes no permit is needed for work by TouchSource or its contractors. <p>Client Requirements:</p> <ul style="list-style-type: none"> - Client must have electrical outlets and data at the specific location of the product installation location in alignment with requirements provided before the technician arriving. - Client to provide an on-site contact to confirm the location of work, and allow for delivery of directory to the location before the technician arriving - Client must provide a resource for approval of installation upon completion <p>Additional Cost Considerations:</p> <ul style="list-style-type: none"> - Locations are within 50 miles of a major metro area or additional travel costs may apply - For heightened security (malls, airports, government buildings, etc.) environments, unimpeded access (i.e. Security escort scheduled in advance) to the installation site will be granted from the client before the dispatch - Any wait time due to lack of client readiness, wait times for facility access, or client availability could be billable at a standard hourly rate 	\$900.00	\$900.00 x 1 \$900.00
INSTALL-SS	Site survey of up to (3) installation locations at the same building	\$350.00	\$350.00 x 1 \$350.00
			Total: \$12,135.50

How we execute the solution – Wall Mounted Pantella



Pantella 43" Touch Display	Pricing
Pantella 43" Touch Display	\$7,900.00
Extended Warranty (5yrs coverage)	\$987.50
Installation with site survey	\$1250.00
Shipping	\$583.00
Pantella 55" Touch Display	Pricing
Pantella 55" Touch Display	\$11,450.00
Extended Warranty (5yrs coverage)	\$1,431.25
Installation with site survey	\$1,650
Shipping	\$956.00

Prices are subject to change, and if planning for deployment in 2026, we recommend adding 15% to account for price increases due to macroeconomic changes

ESPAÑOL

Stop Germs, Stay Healthy!

Wash hands often with soap and warm water



Use soap



Wash for 20 seconds



Rinse well



Dry

When sick, stay home



Cover coughs and sneezes



¡Detenga los gérmenes, manténgase saludable!

- Lávese las manos frecuentemente con agua y jabón
- Lávese por 20 segundos
- Cubra su boca al toser y estornudar
- Quédese en casa cuando está enfermo

Public Health Seattle & King County



Bus Stop	Bus Service	Days to Service
101	Jefferson 300 AM	10
102	Jefferson 300 AM	11
103	Jefferson 300 AM	12
104	Jefferson 300 AM	13
105	Jefferson 300 AM	14
106	Jefferson 300 AM	15
107	Jefferson 300 AM	16
108	Jefferson 300 AM	17
109	Jefferson 300 AM	18
110	Jefferson 300 AM	19
111	Jefferson 300 AM	20
112	Jefferson 300 AM	21
113	Jefferson 300 AM	22
114	Jefferson 300 AM	23
115	Jefferson 300 AM	24
116	Jefferson 300 AM	25
117	Jefferson 300 AM	26
118	Jefferson 300 AM	27
119	Jefferson 300 AM	28
120	Jefferson 300 AM	29
121	Jefferson 300 AM	30
122	Jefferson 300 AM	31
123	Jefferson 300 AM	32
124	Jefferson 300 AM	33
125	Jefferson 300 AM	34
126	Jefferson 300 AM	35
127	Jefferson 300 AM	36
128	Jefferson 300 AM	37
129	Jefferson 300 AM	38
130	Jefferson 300 AM	39
131	Jefferson 300 AM	40
132	Jefferson 300 AM	41
133	Jefferson 300 AM	42
134	Jefferson 300 AM	43
135	Jefferson 300 AM	44
136	Jefferson 300 AM	45
137	Jefferson 300 AM	46
138	Jefferson 300 AM	47
139	Jefferson 300 AM	48
140	Jefferson 300 AM	49
141	Jefferson 300 AM	50
142	Jefferson 300 AM	51
143	Jefferson 300 AM	52
144	Jefferson 300 AM	53
145	Jefferson 300 AM	54
146	Jefferson 300 AM	55
147	Jefferson 300 AM	56
148	Jefferson 300 AM	57
149	Jefferson 300 AM	58
150	Jefferson 300 AM	59
151	Jefferson 300 AM	60
152	Jefferson 300 AM	61
153	Jefferson 300 AM	62
154	Jefferson 300 AM	63
155	Jefferson 300 AM	64
156	Jefferson 300 AM	65
157	Jefferson 300 AM	66
158	Jefferson 300 AM	67
159	Jefferson 300 AM	68
160	Jefferson 300 AM	69
161	Jefferson 300 AM	70
162	Jefferson 300 AM	71
163	Jefferson 300 AM	72
164	Jefferson 300 AM	73
165	Jefferson 300 AM	74
166	Jefferson 300 AM	75
167	Jefferson 300 AM	76
168	Jefferson 300 AM	77
169	Jefferson 300 AM	78
170	Jefferson 300 AM	79
171	Jefferson 300 AM	80
172	Jefferson 300 AM	81
173	Jefferson 300 AM	82
174	Jefferson 300 AM	83
175	Jefferson 300 AM	84
176	Jefferson 300 AM	85
177	Jefferson 300 AM	86
178	Jefferson 300 AM	87
179	Jefferson 300 AM	88
180	Jefferson 300 AM	89
181	Jefferson 300 AM	90
182	Jefferson 300 AM	91
183	Jefferson 300 AM	92
184	Jefferson 300 AM	93
185	Jefferson 300 AM	94
186	Jefferson 300 AM	95
187	Jefferson 300 AM	96
188	Jefferson 300 AM	97
189	Jefferson 300 AM	98
190	Jefferson 300 AM	99
191	Jefferson 300 AM	100
192	Jefferson 300 AM	101
193	Jefferson 300 AM	102
194	Jefferson 300 AM	103
195	Jefferson 300 AM	104
196	Jefferson 300 AM	105
197	Jefferson 300 AM	106
198	Jefferson 300 AM	107
199	Jefferson 300 AM	108
200	Jefferson 300 AM	109
201	Jefferson 300 AM	110
202	Jefferson 300 AM	111
203	Jefferson 300 AM	112
204	Jefferson 300 AM	113
205	Jefferson 300 AM	114
206	Jefferson 300 AM	115
207	Jefferson 300 AM	116
208	Jefferson 300 AM	117
209	Jefferson 300 AM	118

Case Study: The City of Fresno



Reliable public access to up-to-date city information, points of common interest, programs and events

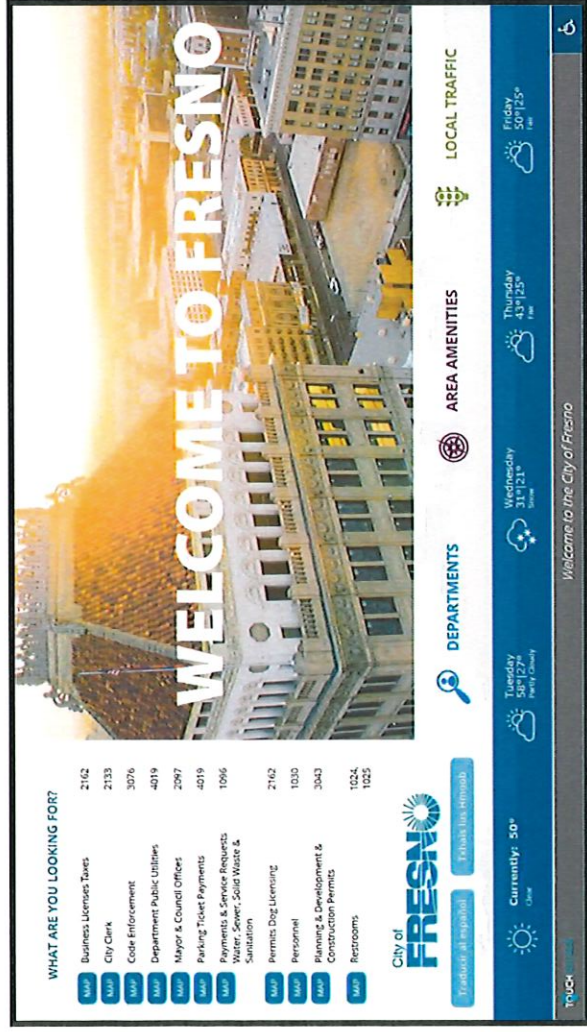

Elegant outdoor-rated enclosure, comprehensive support, and a customized engaging design

Physical Experience

Support Experience

Content Experience

Future Experience



TouchSource Wayfinding

Actual Customer Maps

FEATURES

- Animated paths
- Directions-on-the-go
- Automated tenant location updates
- Branded designs
- Layered 2D or 3D maps
- Station-to-station wayfinding
- QR Codes and text-to-mobile maps



Visit touchsource.com
to learn more

CONTACT US

(866) 476-1872

info@touchsource.com

2D

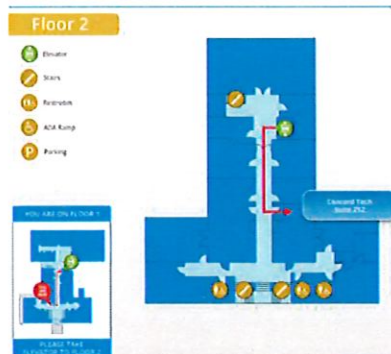
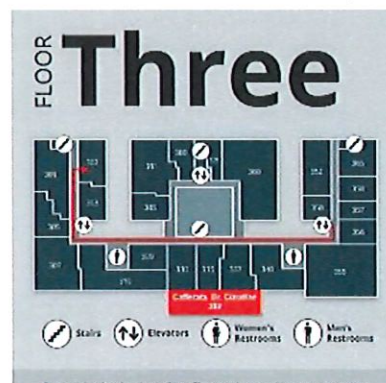

3D

Second Floor

